



Auto-Sleepers
MOTORHOMES OF EXCELLENCE

Dream Discover Explore

2018 | Collection

Motorhomes of Excellence. Made in Great Britain



This is Freedom. Go Explore.

Start Your Adventure

Life is full of adventure; whether you are someone who travels the world seeking the thrill of unique experiences or someone who relishes in the marvels of local captivations, adventure can be found around every corner.

Whatever your pursuits, don't settle for second best, with Auto-Sleepers you can take luxury wherever you go. So whatever you set your sights on, your next adventure starts here.

Contents

6	Peugeot Van Conversions
24	Peugeot Coachbuilts
40	Peugeot AL-KO Coachbuilts
50	Mercedes Coachbuilts
66	Coachbuilt Personalisation
68	Grade 3 Insulation
69	Chassis Features and Options
74	Habitation Climate Control
76	Service
77	Warranty
78	Weights & Dimensions



Discover the world with Auto-Sleepers

Auto-Sleepers has over 54 years experience in meeting the needs of customers who are looking for the best in British built motorhomes. Based at Willersey in the Cotswolds, we still take great pride in our hand craftsmanship and design expertise. Great time, care and effort go into the making of an Auto-Sleepers motorhome and it shows. The furniture, fittings and fitments are all of the highest quality, modern and stylish coupled with quality and innovation, all hand built to offer many years of pleasure. And because our designers use and live with our motorhomes, they know from experience what works and how to make the best use of every cubic centimetre of interior space. That's why so many of our customers keep coming back to us.



Power With Economy

The class leading Auto-Sleepers Motorhome range have a high specification befitting their flagship status and are built on the latest Euro 6 compliant range of Diesel engines, combining power with performance yet being environmentally friendly with low emissions.



Made in the UK



Safety First And Foremost

Being safe in your vehicle is paramount. All Auto-Sleepers models have obtained EC Whole Vehicle Type Approval. That is why the forward facing seating in Auto-Sleepers' conversions is tested to European seat belt anchorage standards. All models comply with British and European safety standards as independently verified by the National Caravan Council (NCC) and VCA.



Award-Winning Manufacturer

Auto-Sleepers have been building motorhomes of exceptional quality for over fifty years. Our motorhomes are hand built by experienced craftsmen combining practicality with internal and external design innovations. Never before have these qualities been better combined than in the latest Auto-Sleepers range. For those who aspire – arrive in style with an Auto-Sleeper.





Peerless & Refined

Peugeot Van Conversions

Our Panel Van Conversions are versatile vehicles, perfect for both everyday trips or longer holidays away. Their practical size will give you confidence when negotiating narrow country lanes, and finding a parking space at the supermarket. Inside, you'll find the luxury and quality you'd expect of an Auto-Sleeper motorhome.

Models

7

Min Berth



Max. Berth



What's Inside?



- A. 160bhp Peugeot Euro 6 engine
- B. Fiat Comfort-Matic 130/150bhp engine*
- C. Cab air conditioning, cruise control*, digital DAB radio, Bluetooth®, passenger air-bag & Garmin Sat-Nav*
- D. **Truma iNet Control Box**
- E. Choice of Luxurious Limewash or Verada Oak furniture with chrome fixtures and fittings
- F. TV aerial & longitudinal styling roof bars
- G. 80W solar panel*
- H. Flush fitting, stylish and interior insulating athermically treated privacy glass side windows
- I. Thule (Omnistor) awning*
- J. Truma Aventa roof air-conditioning with iNet for habitation climate control*
- K. LED strip awning light
- L. Colour reversing camera*
- M. External TV socket
- N. External BBQ point
- O. Spare wheel and carrier with a remote tyre pressure valve
- P. AL-KO Air Top suspension*
- Q. 25 Litre underfloor mounted LPG gas tank
- R. Fully featured kitchens
- S. Designer 'Catalan', '**Casa Milà**' & '**Sagrada**' fabric options
- T. Alloy wheels*
- U. LED daytime running lights
- V. Front fog lights*
- W. **Trackstar Leisure CAT6 Vehicle Tracker with 1 year free subscription**

Key Features



160bhp Peugeot Euro Engine

Drive with confidence the 2018 Auto-Sleepers range features powerful 160bhp engines as standard

Optional 130/150bhp Fiat Comfort-matic

Optional Fiat Ducato 130bhp or 150bhp Comfort-matic gearbox available on all Auto-Sleeper 2018 Peugeot models.

AL-KO

AIR TOP

AL-KO Air-Top Suspension

For enhanced performance Peugeot's twin leaf rear axle suspension has been upgraded to AL-KO's Air-Top system as standard



Grade 3 Fully Insulated

All our van conversions feature Grade III Classification for heating and thermal insulation.



80W Solar Panel

Be more self-sufficient and save money on your next holiday thanks to the included Solar Panel.



Underfloor Mounted LPG Tank

25 litre underfloor mounted LPG gas tank installed, offering hassle free practicality with numerous benefits

Compact Versatility



Symbol

The iconic Auto-Sleeper Symbol is sleek, compact, and offers full versatility, promising to cope with both short and extended getaways. The MWB chassis is super-agile yet the Symbol does not compromise in space or layout due to the innovative interior design.



Rear
Travel
Seat



3



2

Interior Layout

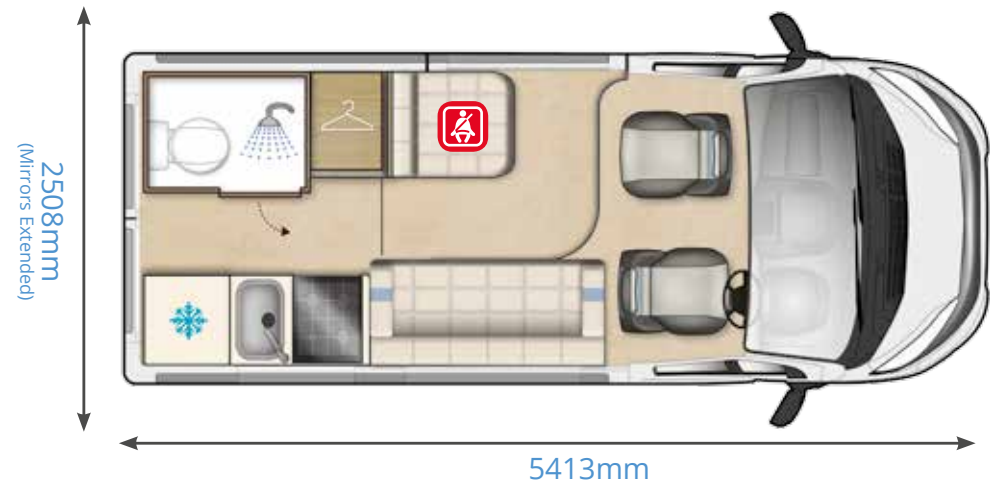



Sleeping Options

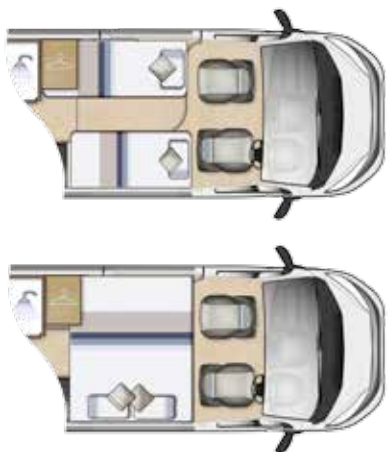

Key Features

- Smallest Peugeot model available with single beds option
- 25 litre underfloor mounted LPG gas tank
- AL-KO Air-Top & Twin Leaf rear suspension*
- Thule (Omnistor) canopy awning*
- Reversing camera with Bluetooth® feed to Caravan Club approved Garmin SAT NAV*
- **Truma iNet Control Box**
- **Trackstar Leisure CAT6 Vehicle Tracker with 1 year free subscription**
- Athermic flush fitting & insulating privacy glass
- Alloy wheels* plus spare wheel & carrier
- 4 exterior colours including 3 metallic finishes
- Colour-coded front bumper and door handles**
- 80W solar panel*
- External BBQ socket
- Fully featured kitchens with worktop extensions
- Truma Comfort air-conditioning#
- Turbo Diesel 160bhp Peugeot engine as standard
- Optional Fiat Ducato 130/150bhp Comfort-Matic engine#

Specification

- Vehicle Height (incl TV aerial) - 2640mm
- MTPLM - 3300kg
- MIRO - 2815kg
- Maximum User Payload - 485kg
- Essential Habitation Equipment - 10kg
- Fresh Water Tank - 69ltrs
- Waste Water Tank - 40ltrs



*Premium Pack #Optional **Bumper only on Fiat Ducato chassis **New for 2018**



Commodious Comfort



Stanway

The Stanway is an open and practical layout that perfectly emulates the feeling of space evident in larger van conversions. A flexible interior design with a well appointed rear corner kitchen, complete with its own coffee maker, sits alongside a corner washroom. The dual functionality in the lounge with additional travelling seats included ensures there are no compromises when it comes to touring in true comfort.



Rear
Travel
Seat



4



2

Interior Layout

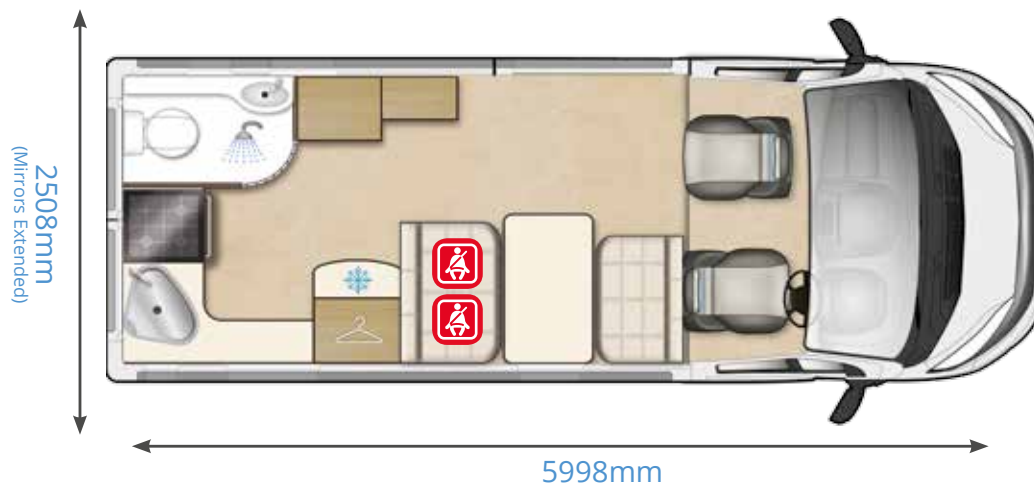

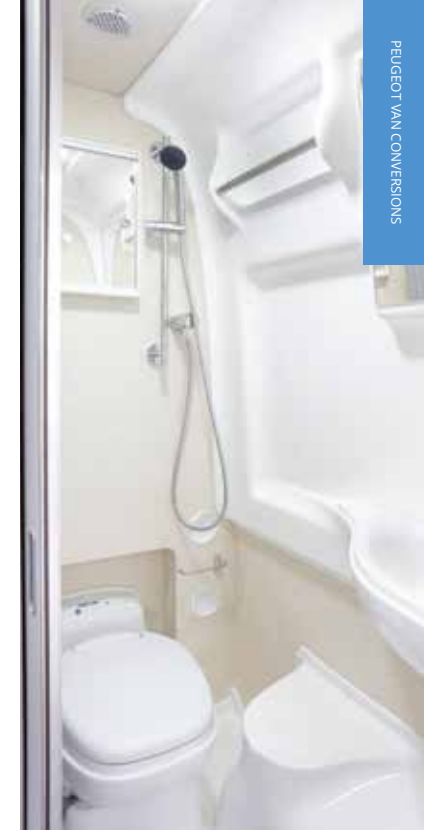

Sleeping Options



Key Features

- Spacious front dinette with 2 forward facing travel seats
- 25 litre underfloor mounted LPG gas tank
- AL-KO Air-Top & Twin Leaf rear suspension*
- Thule (Omnistor) canopy awning*
- Reversing camera with Bluetooth® feed to Caravan Club approved Garmin SAT NAV*
- **Truma iNet Control Box**
- **Trackstar Leisure CAT6 Vehicle Tracker with 1 year free subscription**
- Athermic flush fitting & insulating privacy glass
- Alloy wheels* plus spare wheel & carrier
- 4 exterior colours including 3 metallic finishes
- Colour-coded front bumper and door handles**
- 80W solar panel*
- External BBQ socket
- Fully featured kitchens with worktop extensions
- Truma Comfort air-conditioning#
- Turbo Diesel 160bhp Peugeot engine as standard
- Optional Fiat Ducato 130/150bhp Comfort-Matic engine#

Specification

- Vehicle Height (incl TV aerial) - 2640mm
- MTPLM - 3500kg
- MIRO - 2938kg
- Maximum User Payload - 562kg
- Essential Habitation Equipment - 10kg
- Fresh Water Tank - 69ltrs
- Waste Water Tank - 40ltrs

Bed Sizes

- Front Double - 1940 x 1340mm/ 6' 4" x 4' 5"



*Premium Pack #Optional **Bumper only on Fiat Ducato chassis **New for 2018**



The Couples' Choice



Warwick Duo

The Warwick Duo has long been Auto-Sleepers' top selling 2-berth end lounge panel van, thanks in part to the innovative and stylish design features. One can relax in spacious comfort throughout the day and then take full advantage of the versatile sleeping arrangements at night; with a choice of either a large double or practical single bed sleeping positions.



Interior Layout

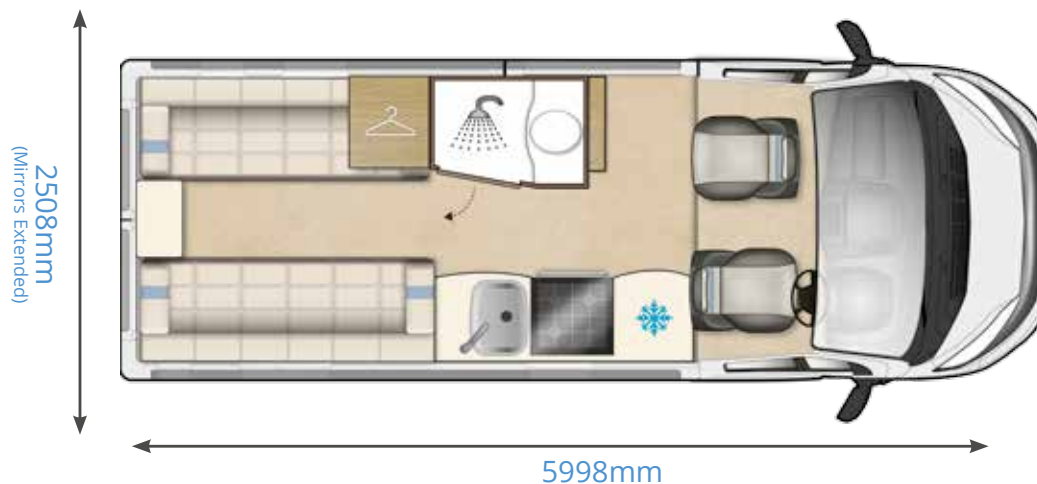

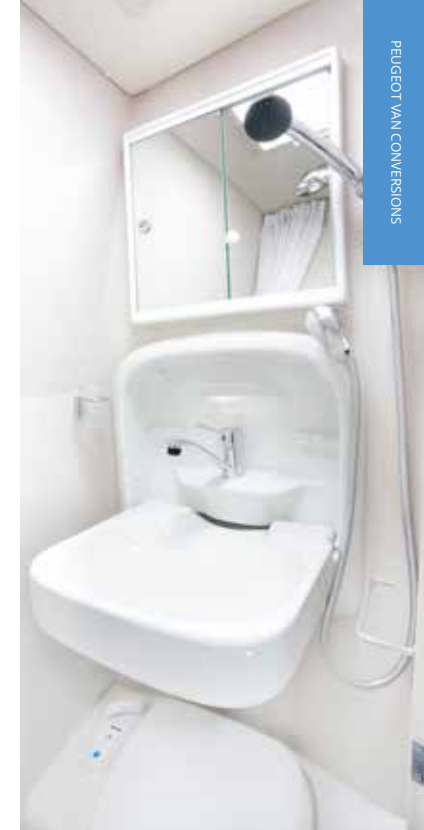

Sleeping Options

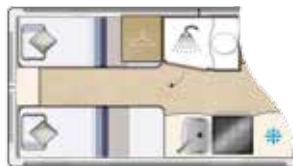

Alternative single seat option available



Key Features

- Spacious rear lounge with full size single beds or double bed
- 25 litre underfloor mounted LPG gas tank
- AL-KO Air-Top & Twin Leaf rear suspension*
- Thule (Omnistor) canopy awning*
- Reversing camera with Bluetooth® feed to Caravan Club approved Garmin SAT NAV*
- **Truma iNet Control Box**
- **Trackstar Leisure CAT6 Vehicle Tracker with 1 year free subscription**
- Athermic flush fitting & insulating privacy glass
- Alloy wheels* plus spare wheel & carrier
- 4 exterior colours including 3 metallic finishes
- Colour-coded front bumper and door handles**
- 80W solar panel*
- External BBQ socket
- Fully featured kitchens with worktop extensions
- Truma Comfort air-conditioning*
- Turbo Diesel 160bhp Peugeot engine as standard
- Optional Fiat Ducato 130/150bhp Comfort-Matic engine*

Specification

- Vehicle Height (incl TV aerial) - 2640mm
- MTPLM - 3500kg
- MIRO - 2857kg
- Maximum User Payload - 643kg
- Essential Habitation Equipment - 10kg
- Fresh Water Tank - 69ltrs
- Waste Water Tank - 40ltrs



*Premium Pack #Optional **Bumper only on Fiat Ducato chassis **New for 2018**



The Perfect two plus two



Fairford

Introduced to the iconic Auto-Sleepers van conversion line up in 2017, the Fairford is a spacious four berth built on the extra long wheel based Peugeot Boxer. The van features a versatile twin lounge layout; practical dinette seating in the front leads through to a spacious rear living area to deliver maximum flexibility in use.



Interior Layout

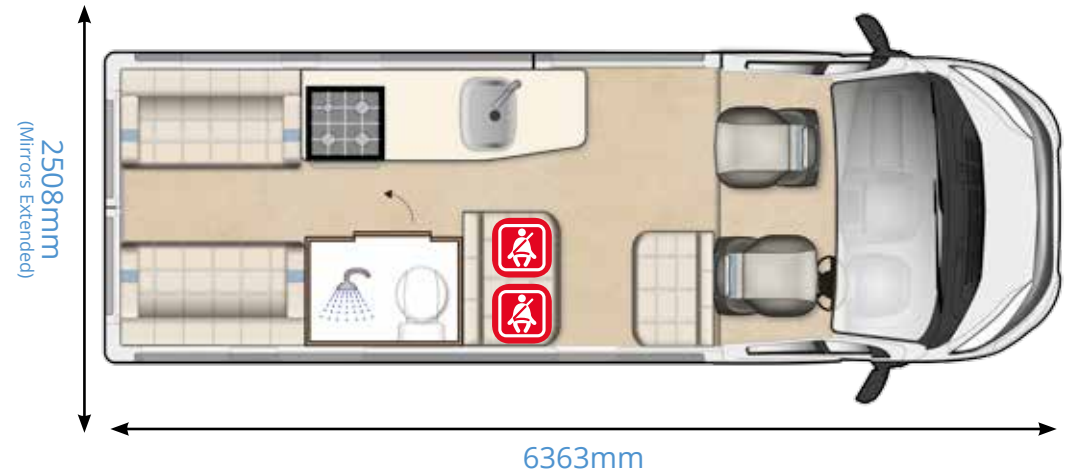



Sleeping Options

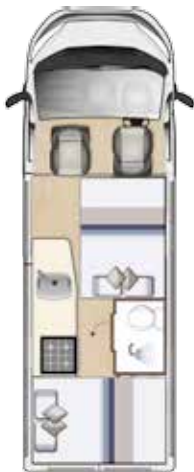

Key Features

- Luxurious front and rear lounge model offering total flexibility
- 25 litre underfloor mounted LPG gas tank
- AL-KO Air-Top & Twin Leaf rear suspension*
- Thule (Omnistor) canopy awning*
- Reversing camera with Bluetooth® feed to Caravan Club approved Garmin SAT NAV*
- **Truma iNet Control Box**
- **Trackstar Leisure CAT6 Vehicle Tracker with 1 year free subscription**
- Athermic flush fitting & insulating privacy glass
- Alloy wheels* plus spare wheel & carrier
- 4 exterior colours including 3 metallic finishes
- Colour-coded front bumper and door handles**
- 80W solar panel*
- External BBQ socket
- Fully featured kitchens with worktop extensions
- Truma Comfort air-conditioning#
- Turbo Diesel 160bhp Peugeot engine as standard
- Optional Fiat Ducato 130/150bhp Comfort-Matic engine#

Specification

- Vehicle Height (incl TV aerial) - 2640mm
- MTPLM - 3500kg
- MIRO - 3076kg
- Maximum User Payload - 424kg
- Essential Habitation Equipment - 10kg
- Fresh Water Tank - 69ltrs
- Waste Water Tank - 40ltrs



*Premium Pack #Optional **Bumper only on Fiat Ducato chassis **New for 2018**



Classic Ensuite



Kemerton XL

Offering everything one could ever need in a van conversion and designed to offer you the very best in luxurious living. With a full width bathroom, a fully appointed kitchen and spacious lounge area, the Kemerton XL truly boasts a specification second to none.



Rear
Travel
Seat



3



2

Interior Layout

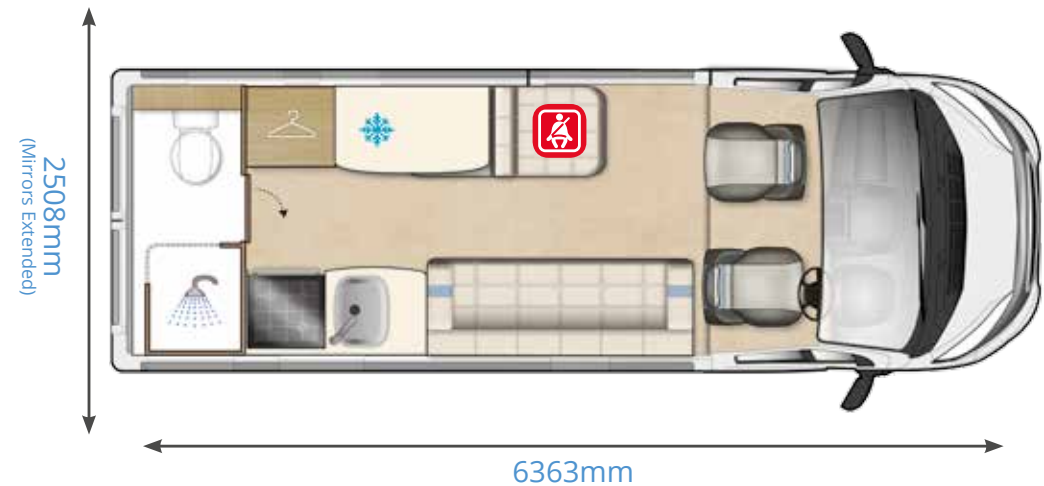



Sleeping Options

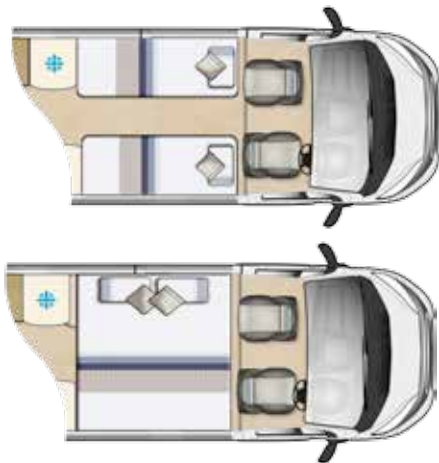

Key Features

- Full width washroom with separate shower
- 25 litre underfloor mounted LPG gas tank
- AL-KO Air-Top & Twin Leaf rear suspension*
- Thule (Omnistor) canopy awning*
- Reversing camera with Bluetooth® feed to Caravan Club approved Garmin SAT NAV*
- **Truma iNet Control Box**
- **Trackstar Leisure CAT6 Vehicle Tracker with 1 year free subscription**
- Athermic flush fitting & insulating privacy glass
- Alloy wheels* plus spare wheel & carrier
- 4 exterior colours including 3 metallic finishes
- Colour-coded front bumper and door handles**
- 80W solar panel*
- External BBQ socket
- Fully featured kitchens with worktop extensions
- Truma Comfort air-conditioning#
- Turbo Diesel 160bhp Peugeot engine as standard
- Optional Fiat Ducato 130/150bhp Comfort-Matic engine#

Specification

- Vehicle Height (incl TV aerial) - 2640mm
- MTPLM - 3500kg
- MIRO - 3054kg
- Maximum User Payload - 446kg
- Essential Habitation Equipment - 10kg
- Fresh Water Tank - 69ltrs
- Waste Water Tank - 40ltrs



*Premium Pack #Optional **Bumper only on Fiat Ducato chassis **New for 2018**



King of the Road



Kingham

Offering majestic luxury; The Kington raises the bar to new heights. The Kington features a rear fixed double bed, an indulgence normally reserved for coachbuilt motorhomes. For optimum sleeping comfort the bed can slide back to lift the rear section, providing additional backrest support. At the front, a fully featured kitchen and swivelling cab combine to create a practical living area. For those looking for coachbuilt luxury in a compact van conversion the Kington is simply a must have.



Interior Layout

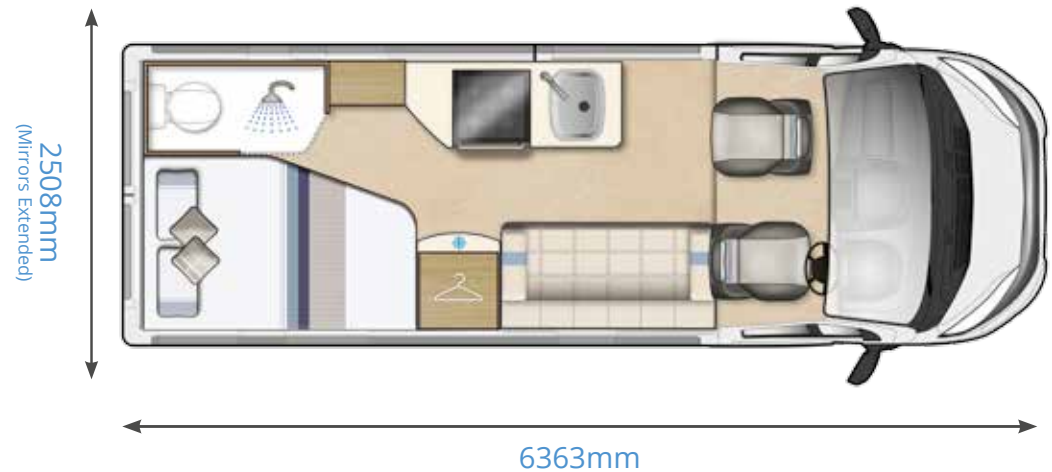



Sleeping Options



Key Features

- Luxurious double fixed bed
- 25 litre underfloor mounted LPG gas tank
- AL-KO Air-Top & Twin Leaf rear suspension*
- Thule (Omnistor) canopy awning*
- Reversing camera with Bluetooth® feed to Caravan Club approved Garmin SAT NAV*
- **Truma iNet Control Box**
- **Trackstar Leisure CAT6 Vehicle Tracker with 1 year free subscription**
- Athermic flush fitting & insulating privacy glass
- Alloy wheels* plus spare wheel & carrier
- 4 exterior colours including 3 metallic finishes
- Colour-coded front bumper and door handles**
- 80W solar panel*
- External BBQ socket
- Fully featured kitchens with worktop extensions
- Truma Comfort air-conditioning#
- Turbo Diesel 160bhp Peugeot engine as standard
- Optional Fiat Ducato 130/150bhp Comfort-Matic engine#

Specification

- Vehicle Height (incl TV aerial) - 2640mm
- MTPLM - 3500kg
- MIRO - 3067kg
- Maximum User Payload - 433kg
- Essential Habitation Equipment - 10kg
- Fresh Water Tank - 69ltrs
- Waste Water Tank - 40ltrs



Bed Sizes

- Front Double - 1900 x 1200mm/ 6' 3" x 4' 0"

*Premium Pack #Optional **Bumper only on Fiat Ducato chassis **New for 2018**



Ergonomically
Stunning



Warwick XL

The Warwick XL builds on the concept of the ever-popular Warwick Duo providing a huge rear lounge which converts quickly into full-length single beds, or an exceedingly comfortable double bed. Alongside is a spacious bathroom with a fully separate shower and a large fully appointed kitchen on the nearside to provide truly open-plan accommodation ideal for both short breaks and long term touring.



Interior Layout

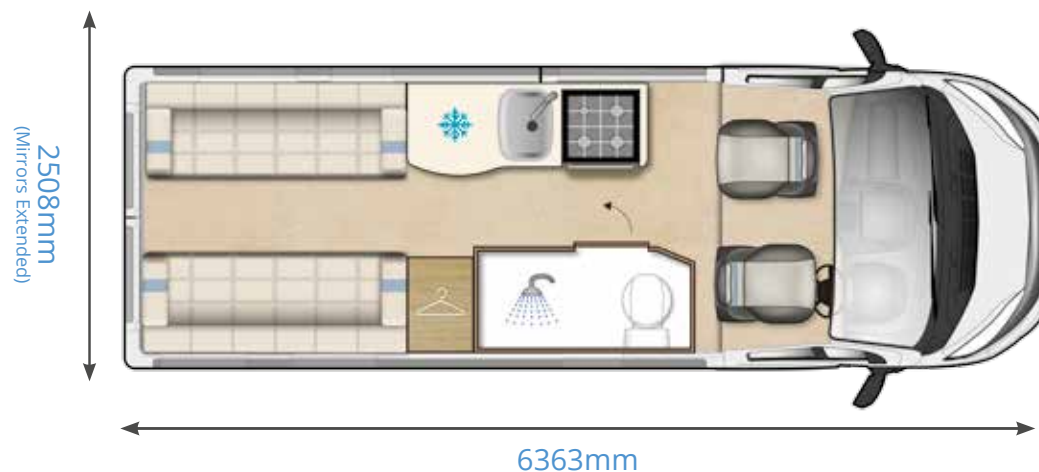



Sleeping Options



Key Features

- Spacious lounge with full size single beds
- 25 litre underfloor mounted LPG gas tank
- AL-KO Air-Top & Twin Leaf rear suspension*
- Thule (Omnistor) canopy awning*
- Reversing camera with Bluetooth® feed to Caravan Club approved Garmin SAT NAV*
- **Truma iNet Control Box**
- **Trackstar Leisure CAT6 Vehicle Tracker with 1 year free subscription**
- Athermic flush fitting & insulating privacy glass
- Alloy wheels* plus spare wheel & carrier
- 4 exterior colours including 3 metallic finishes
- Colour-coded front bumper and door handles**
- 80W solar panel*
- External BBQ socket
- Fully featured kitchens with worktop extensions
- Truma Comfort air-conditioning#
- Turbo Diesel 160bhp Peugeot engine as standard
- Optional Fiat Ducato 130/150bhp Comfort-Matic engine#

Specification

- Vehicle Height (incl TV aerial) - 2640mm
- MTPLM - 3500kg
- MIRO - 3031kg
- Maximum User Payload - 469kg
- Essential Habitation Equipment - 10kg
- Fresh Water Tank - 69ltrs
- Waste Water Tank - 40ltrs



*Premium Pack #Optional **Bumper only on Fiat Ducato chassis **New for 2018**



The Specs >

Cutting Edge Engines

Auto-Sleepers 2018 Peugeot range motorhomes are fitted with Peugeot's BlueHDi 2.0L engines. BlueHDi is the name given to Peugeot's latest generation of fuel and environmentally efficient Diesel engines.

Generated from a world-famous diesel heritage and innovative, automotive engineering excellence, BlueHDi complies with Euro 6 emission standards to deliver a driving experience rich in power and performance but with exceptional fuel economy and CO2 emissions.

BlueHDi engines meet Euro 6 standards thanks to Selective Catalytic Reduction (SCR) and Particle Filtration processes. A three stage cleansing process specifically targets the pollutants of diesel combustion, removing hydrocarbons and carbon monoxide, reducing nitrogen oxides by up to 90% and eliminating 99.9% of particulates:

- **Stage One** - the oxidation catalytic converter eliminates the HC and the CO2, transforming them into water (H2O) and carbon dioxide (CO2)
- **Stage Two** - the SCR (Selective Catalytic Reduction) transforms the nitrogen oxides (NOx) into water and nitrogen (N2), which is the main constituent of air (78%), due to the addition of AdBlue® (mixture of urea and water)
- **Stage Three** - the Particulate Emission Filter eliminates 99.9% of the particulates by number

BlueHDi delivers the cleanest diesel engine possible and exceptional fuel economy specification and refinement.



AL-KO Air-Top Suspension

The AL-KO Air-Top system is fitted as a proven performance enhancing upgrade to Peugeot's own twin leaf rear axle suspension.

The system increases roll and road holding stability and provides significantly improved driving comfort even under full load.

The dual circuit system is entirely maintenance free and can be used independently on each rear wheel to assist levelling out uneven loading whilst travelling and/or onsite when parking on uneven ground.

AL-KO



Peace Of Mind On The Road

The standard safety features of the Auto-Sleepers 2018 Peugeot range include: ESP - electronic stability program, ABS - Anti-lock Braking System with EBA - Emergency Braking Assistance, EBFD - Electronic Brake Force Distribution, disc brakes, passenger and driver's airbags, fuel supply safety cut off, driver's seat belt indicator and safety auto-reverse windows.



Underfloor Mounted LPG Tank

All 2018 Auto-Sleeper Peugeot Van Conversions have a 25 litre underfloor mounted LPG gas tank installed, offering hassle free practicality with numerous benefits including -

- Readily available from 1000's of petrol stations throughout Great Britain and Europe.
- Convenience personified, refilling them is as easy as filling the fuel tank
- No heavy bottles to lift, carry or manhandle
- No middle of the night change overs required
- Economical to use at approximately half the cost of cylinders, cost per litre typically only 60p
- Interior space saving, the tank is externally mounted to the underside of the Motorhome
- Easy read LED tank gauge and an Auto-Stop feature to prevent any chance of overfilling
- Reliable and safety proven, extensively tested for peace of mind and fully approved under European Whole Vehicle Type Approval Legislation.



Athermic Windows

Auto-Sleepers' Peugeot van conversions feature factory bonded athermic windows. These windows provide a stylish and practical solution that reflects heat in both directions, provides insulation for year round use, offers improved security and are tinted for maximum privacy.



Base Vehicle Specification

- Peugeot Twin Leaf rear suspension and AL-KO dual Air-Top suspension system installed*
- Turbo Diesel 160bhp Euro 6 manual engine
- **Trackstar Leisure CAT6 Vehicle Tracker with 1 year free subscription**
- ESP, ABS brakes with EBA, EBSD as standard
- Optional Fiat Ducato 130/150bhp Comfort-Matic Engines#
- Alloy wheels*
- Cruise control*
- Cab air conditioning*
- Leather steering wheel and gear knob*
- Battery Isolator on ignition
- Bluetooth® hands free connectivity and steering wheel controls
- USB and Auxiliary input sockets
- Digital DAB radio with Bluetooth® connectivity
- Single key central locking for cab and habitation door
- Driver and passenger airbags
- Driver and passenger seat armrest
- Power assisted steering
- Electrically heated and adjustable door mirrors
- Electric cab windows
- 12v socket
- UV filtering tinted glass
- Spare wheel & carrier with remote tyre pressure valve
- LED daytime running lights
- Rear fog lights
- Front fog lights#

Exterior General

- Four body colours to choose from including 3 metallic paint colours
- Colour co-ordinated front bumper and door handles##
- Athermally treated privacy glass with concertina blinds & flyscreens
- Space saving 25 litre under floor mounted LPG gas tank fitted with LED level gauge
- Reversing camera with Bluetooth® feed to Caravan Club approved Garmin SAT NAV*
- 80W solar panel*
- LED strip awning light
- Multi directional TV aerial
- Thule (Omnistor) roof mounted canopy awning*
- External TV socket
- External gas BBQ point
- External 230v mains socket
- Styling longitudinal roof bars
- Electric slide-out entrance step with auto retract on engine start

Interior General

- Choice of Luxurious Limewash or Verada Oak furniture with chrome fixtures and fittings
- Panoramic opening rooflight
- Privacy blinds & flyscreen's to all opening windows
- Choice of Designer 'Catalan', 'Casa Milà' or 'Sagrada' fabrics providing luxurious interior soft furnishings
- High quality Reflex™ foam upholstery
- Memory foam mattress**
- Removable interior carpets including the cab
- LED spotlights and roof lighting with a power saving of up to 70%
- Scatter cushions
- Fire extinguisher
- Swivel cab seats on all front lounge models
- Gas strut assisted bed tops and drop down access door to under seat storage space
- Swivel Passenger seat (Warwick XL)
- Over-cab storage compartment
- Spacious wardrobe
- Range of high & low level storage lockers
- Cocktail cabinet with crystal wine glasses
- Smoke and carbon monoxide alarms
- Freestanding and/or single leg tables
- Low level LED lighting in the elevated cab step fascia

Electrics and Plumbing

- LCD control panel
- Split charged leisure battery
- Four 230v sockets & two 12v sockets
- Drive Safe Regulator
- Electric mains hook up lead
- **Truma iNet Control Box**
- Truma dual fuel Combi blown air central heating and water heater
- Truma Comfort air-conditioning#
- 69 litre fresh water tank
- 40 litre waste tank
- Large bore waste pipe work for efficient drainage

Kitchen

- Spacious and fully equipped with additional work surface
- Hob with 3 burner hob plus electronic ignition oven and grill
- 230v microwave oven
- 12 volt extractor fan with down-lighters
- Cutlery drawer
- 3 way large refrigerator with freezer compartment
- Kitchen centre sink incorporating draining board and cutlery drying rack
- Kitchen roll holder
- Melamine crockery set & cooler bag

Bathroom

- Combined shower and toilet compartment with integrated washbasin
- Vanity cupboard/storage
- Separate shower cubicle with extractor fan (Kemerton XL and Warwick XL)
- Storage cupboard
- Electric flush cassette toilet with separate header tank (model specific)
- Chrome fixtures and fittings
- Anti slip shower mat
- Ducted blown air outlet
- LED lighting
- Roof vent with flyscreen

Premium Pack

- Alloy wheels
- AL-KO dual Air-Top suspension system
- Cab air conditioning
- Thule (Omnistor) canopy awning
- Colour reversing camera and Garmin SAT NAV
- Cruise control
- 80W solar panel
- Leather steering wheel and gear knob

Media Pack

- Maxview VuQube II Automatic Satellite System
 - Twin LNB to support 2 receivers
 - Fully Automatic Tuning
 - Receives transmissions from Astra 1, Astra 2, Astra 3 and Hotbird
 - Compatible with any SD/HD Free to air satellite receivers

Winter Pack

- Concertina cab blinds in lieu of cab curtains
- Fresh & waste water tank heater blanket
- Truma Combi heater upgrade
- Wheel arch insulation blankets

Choice Of Colours

Peugeot van conversions are available in a choice of 4 colours.





Unrivalled Luxury

Peugeot Coachbuilts

Peugeot Coachbuilts remain as one of our most popular ranges, offering customers luxuriously styled interiors and optimum driving performance, built to our exceptional quality standards. Models are available as both low profile and highline Coachbuilt models with a choice of Short, Medium, and Long wheel base chassis.

Models

6

Min Berth



Max. Berth



What's Inside?



- A. 160bhp Peugeot Euro 6 engine
- B. Fiat Comfort-Matic 130/150bhp engine*
- C. Wing mirror aerial
- D. Cab air conditioning, cruise control*, digital DAB radio, Bluetooth® & passenger air-bag
- E. **Truma iNet Control Box**
- F. Luxury Valencia or Amarti furniture
- G. Wind-up opening skyview window & panoramic roof-light**
- H. 80W solar panel*
- I. Thule (Omnistor) canopy awning *
- J. **Full scratch and impact resistant GRP body with Platinum sides including GRP Rear Panel with Hella LED Lights**
- K. Full spectrum reversing camera*
- L. Fully featured kitchens
- M. Safe, fire extinguisher, crockery set & crystal glasses
- N. Hartal exterior door c/w sliding door flyscreen
- O. External BBQ & 230v mains socket
- P. Rear corner steadies
- Q. Spare wheel and carrier with a remote tyre pressure valve
- R. Rear mud flaps
- S. Spacious en-suite washroom facilities
- T. Large skirt storage locker, underfloor mounted for space saving
- U. 25 litre under-floor mounted LPG gas tank
- V. Designer 'Catalan', 'Casa Milà' & 'Sagrada' fabric options
- W. Alloy wheels*
- X. Front fog lights*
- Y. Colour coded bumpers
- Z. **Trackstar Leisure CAT6 Vehicle Tracker with 1 year free subscription**

Key Features



160bhp Peugeot Euro Engine

Drive with confidence the 2018 Peugeot coachbuilt range features powerful 160bhp engines as standard

Optional 130/150bhp Fiat Comfort-matic

Optional Fiat Ducato 130bhp or 150bhp Comfort-matic gearbox available on all Auto-Sleeper 2018 Peugeot models.



3.5 Tonne Chassis Models

An range for everyone; Auto-Sleeper Peugeot coachbuilds are built on a lightweight 3500kg chassis, so they can be driven on a standard driving license.



Grade 3 Fully Insulated

All our 2018 Peugeot coachbuilds feature Grade III Classification for heating and thermal insulation.



80W Solar Panel*

Be more self-sufficient and save money on your next holiday thanks to the included Solar Panel.



Underfloor Mounted LPG Tank

25 litre underfloor mounted LPG gas tank installed, offering hassle free practicality with numerous benefits

*Premium pack **Optional ##Bumper only on Fiat Ducato chassis **New For 2018**



Petite Yet Spacious



Nuevo EK

The most compact of motorhomes, which belies the space available inside this iconic model. The EK now its best ever specification and with the inclusion of a space saving and economical LPG gas tank our designers have massively increased internal and external storage space to boot. Quite simply the best just got even better.



Interior Layout

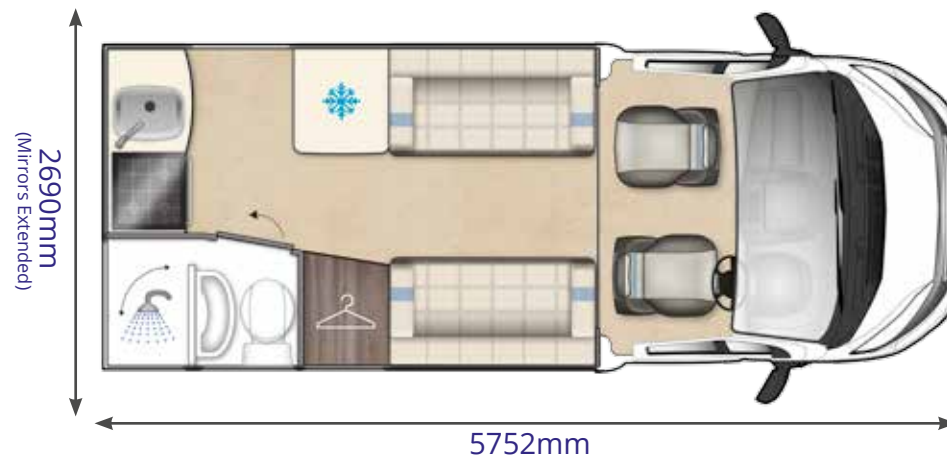



Sleeping Options

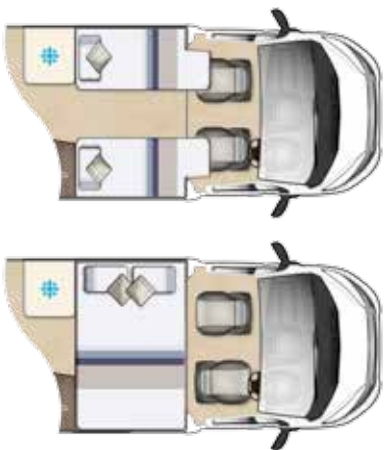

Key Features

- Iconic model with single beds and ever popular end kitchen, under 6m
- 25 litre underfloor mounted LPG gas tank
- 80W solar panel*
- **Truma iNet Control Box**
- **Trackstar Leisure CAT6 Vehicle Tracker with 1 year free subscription**
- External skirt storage locker
- **GRP body with scratch & impact resistant platinum sides including GRP Rear Panel with Hella LED Lights**
- Hartal exterior door c/w sliding door flyscreen
- Opening skyview window (LP only)
- Panoramic wind-up roof-light
- Thule (Omnistor) canopy awning*
- Reversing camera with Bluetooth® feed to Caravan Club approved Garmin SAT NAV*
- Alloy wheels* with spare wheel & carrier
- Leather steering wheel and gear knob*
- External BBQ & 230v mains sockets
- Safe, fire extinguisher, crockery set & crystal glasses
- USB ports
- Turbo Diesel 160bhp Peugeot Euro 6 engine as standard
- Optional Fiat Ducato 130/150bhp Comfort-Matic Engine#

Specification

- Vehicle Height (incl TV aerial) - 2875mm
- MTPLM - 3500kg
- MIRO - 2824kg
- Maximum User Payload - 676kg
- Essential Habitation Equipment - 17kg
- Fresh Water Tank - 102ltrs
- Waste Water Tank - 71ltrs



Bed Sizes

- Front Double - 2100 x 1380mm/ 6' 11" x 4' 6"
- Nearside Single - 1900 x 700mm/ 6' 3" x 2' 4"
- Offside Single - 1880 x 700mm/ 6' 2" x 2' 4"

*Premium pack *Optional **Bumper only on Fiat Ducato chassis **New For 2018**



A Bijou Residence



Nuevo ES

The most compact of motorhomes at 5.75m, which belies the space available inside this iconic model. The ES boasts its best ever specification and with the inclusion of a space saving and economical LPG gas tank our designers have massively increased internal and external storage space to boot. Quite simply the best just got even better.



Interior Layout

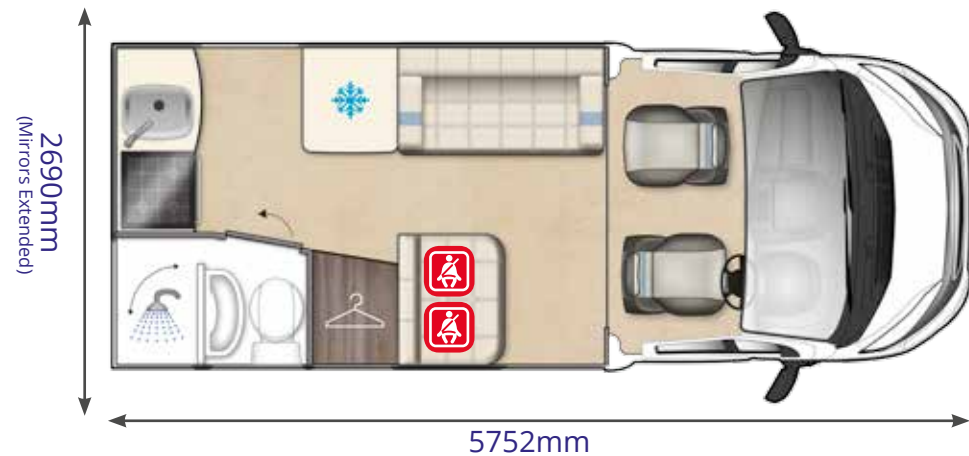



Sleeping Options

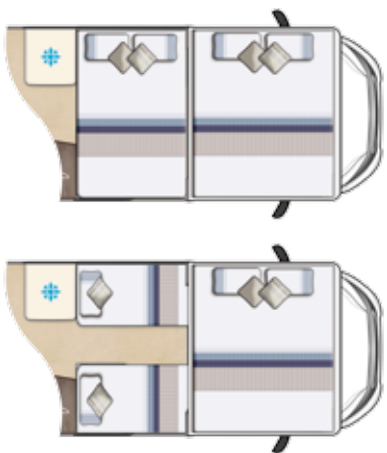

Key Features

- Iconic model, under 6m, rear travel seats, single beds and spacious end kitchen
- 25 litre underfloor mounted LPG gas tank
- 80W solar panel*
- **Truma iNet Control Box**
- **Trackstar Leisure CAT6 Vehicle Tracker with 1 year free subscription**
- External skirt storage locker
- **GRP body with scratch & impact resistant platinum sides including GRP Rear Panel with Hella LED Lights**
- Hartal exterior door c/w sliding door flyscreen
- Opening skyview window (LP only)
- Panoramic wind-up roof-light
- Thule (Omnistor) canopy awning*
- Reversing camera with Bluetooth® feed to Caravan Club approved Garmin SAT NAV*
- Alloy wheels* with spare wheel & carrier
- Leather steering wheel and gear knob*
- External BBQ & 230v mains sockets
- Safe, fire extinguisher, crockery set & crystal glasses
- USB ports
- Turbo Diesel 160bhp Peugeot Euro 6 engine as standard
- Optional Fiat Ducato 130/150bhp Comfort-Matic Engine#

Specification

- Vehicle Height (incl TV aerial) - 3005mm
- MTPLM - 3500kg
- MIRO - 2936kg
- Maximum User Payload - 564kg
- Essential Habitation Equipment - 17kg
- Fresh Water Tank - 102ltrs
- Waste Water Tank - 71ltrs



Bed Sizes

- Front Double - 2100 x 1380mm/ 6' 11" x 4' 6"
- Nearside Single - 1900 x 700mm/ 6' 3" x 2' 4"
- Offside Single - 1800 x 900mm/ 5' 11" x 2' 11"
- Roof Bed - 1940 x 1280mm/ 6' 4" x 4' 2"

*Premium pack *Optional **Bumper only on Fiat Ducato chassis **New for 2018**



Iconic Comfort For Two



Broadway EK TB LP

The EK TB LP builds on the popularity of the Nuevo EK to deliver a truly spacious and comfortable model. A front lounge end kitchen model, the EK TB LP delivers on every front with a huge lounge, which converts quickly at night to provide a choice between full-length singles or a truly luxurious double bed.



Interior Layout

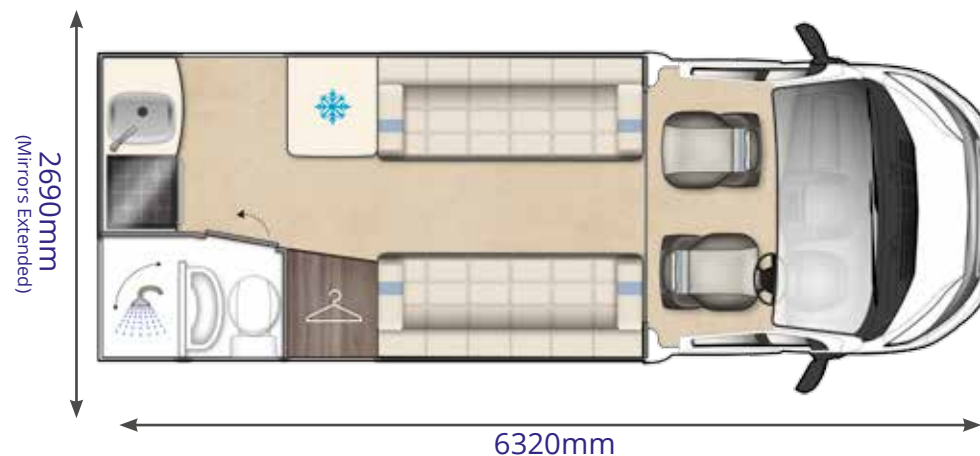

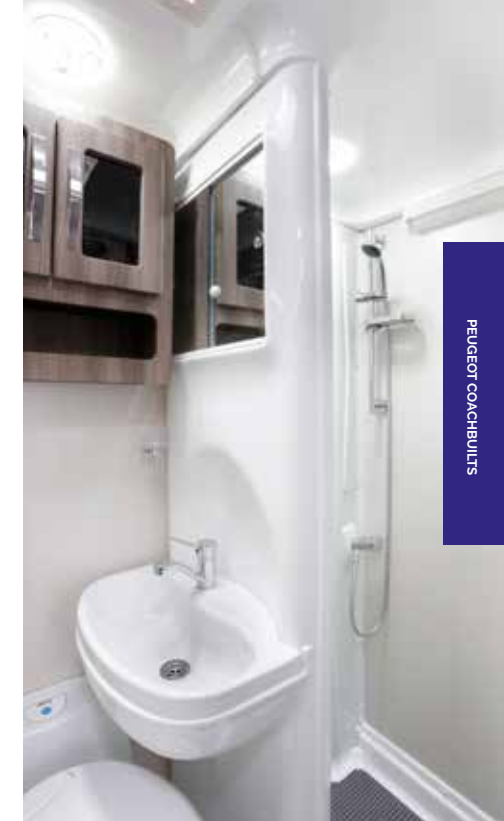

Sleeping Options

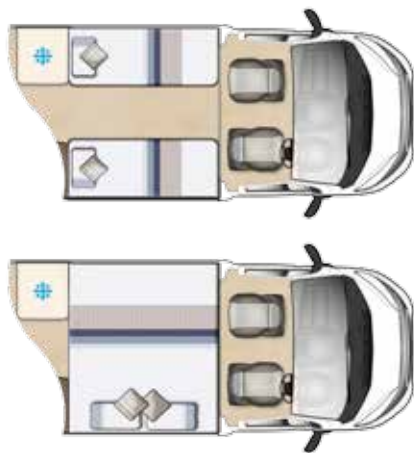

Key Features

- Full single beds, swingwall washroom, end kitchen
- 25 litre underfloor mounted LPG gas tank
- 80W solar panel*
- **Truma iNet Control Box**
- **Trackstar Leisure CAT6 Vehicle Tracker with 1 year free subscription**
- External skirt storage locker
- **GRP body with scratch & impact resistant platinum sides including GRP Rear Panel with Hella LED Lights**
- Hartal exterior door c/w sliding door flyscreen
- Opening skyview window (LP only)
- Panoramic wind-up roof-light
- Thule (Omnistor) canopy awning*
- Reversing camera with Bluetooth® feed to Caravan Club approved Garmin SAT NAV*
- Alloy wheels* with spare wheel & carrier
- Leather steering wheel and gear knob*
- External BBQ & 230v mains sockets
- Safe, fire extinguisher, crockery set & crystal glasses
- USB ports
- Turbo Diesel 160bhp Peugeot Euro 6 engine as standard
- Optional Fiat Ducato 130/150bhp Comfort-Matic Engine#

Specification

- Vehicle Height (incl TV aerial) - 2970mm
- MTPLM - 3500kg
- MIRO - 2969kg
- Maximum User Payload - 531kg
- Essential Habitation Equipment - 17kg
- Fresh Water Tank - 102ltrs
- Waste Water Tank - 71ltrs



*Premium pack *Optional **Bumper only on Fiat Ducato chassis **New for 2018**



Prestigious Comfort



Broadway EB

Epitomising pampered touring, the perfectly proportioned EB combines a superb feature washroom with a spacious lounge and kitchen without sacrificing practicality. The EB retains all the functionality and Maneuverability of a medium wheel base chassis, delivering total freedom to explore comfortably.



Optional
Rear
Travel
Seat



Interior Layout

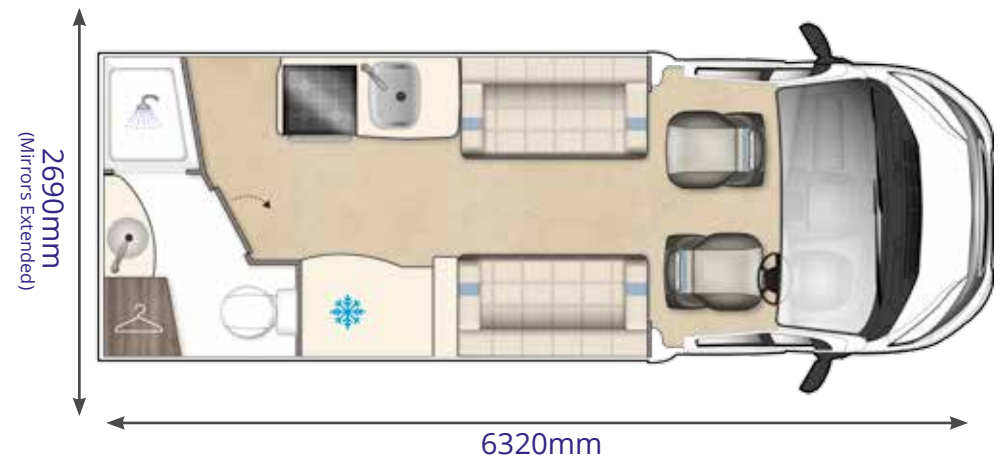



Sleeping Options

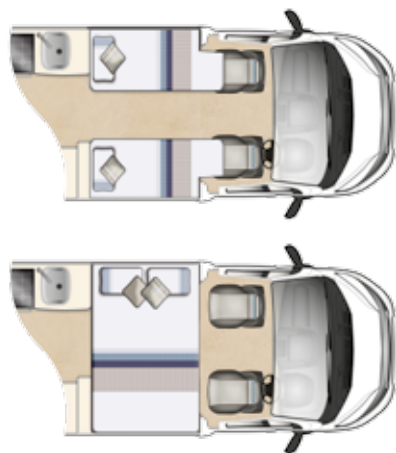

Key Features

- Front lounge, feature kitchen, luxury rear bathroom
- 25 litre underfloor mounted LPG gas tank
- 80W solar panel*
- **Truma iNet Control Box**
- **Trackstar Leisure CAT6 Vehicle Tracker with 1 year free subscription**
- External skirt storage locker
- **GRP body with scratch & impact resistant platinum sides including GRP Rear Panel with Hella LED Lights**
- Hartal exterior door c/w sliding door flyscreen
- Opening skyview window (LP only)
- Panoramic wind-up roof-light
- Thule (Omnistor) canopy awning*
- Reversing camera with Bluetooth® feed to Caravan Club approved Garmin SAT NAV*
- Alloy wheels* with spare wheel & carrier
- Leather steering wheel and gear knob*
- External BBQ & 230v mains sockets
- Safe, fire extinguisher, crockery set & crystal glasses
- USB ports
- Turbo Diesel 160bhp Peugeot Euro 6 engine as standard
- Optional Fiat Ducato 130/150bhp Comfort-Matic Engine#

Specification

- Vehicle Height (incl TV aerial) - 2970mm
- MTPLM - 3500kg
- MIRO - 2981kg
- Maximum User Payload - 519kg
- Essential Habitation Equipment - 17kg
- Fresh Water Tank - 102ltrs
- Waste Water Tank - 71ltrs



Bed Sizes

- Front Double - 2100 x 1350mm/ 6' 11" x 4' 5"
- Nearside Single - 1930 x 700mm/ 6' 4" x 2' 4"
- Offside Single - 1930 x 700mm/ 6' 4" x 2' 4"

*Premium pack *Optional ##Bumper only on Fiat Ducato chassis **New for 2018**



Flexible Family Luxury



Broadway EK

The family friendly EK builds on the strengths of the EK TB LP, adding the flexibility of 2 travelling seats in the rear which allows for safe travelling for up-to 4 people in this perennially popular model. The bathroom offers ingenious space saving functionality whilst the fully appointed kitchen accommodates all of your culinary needs.



Rear
Travel
Seats



4



4

Interior Layout

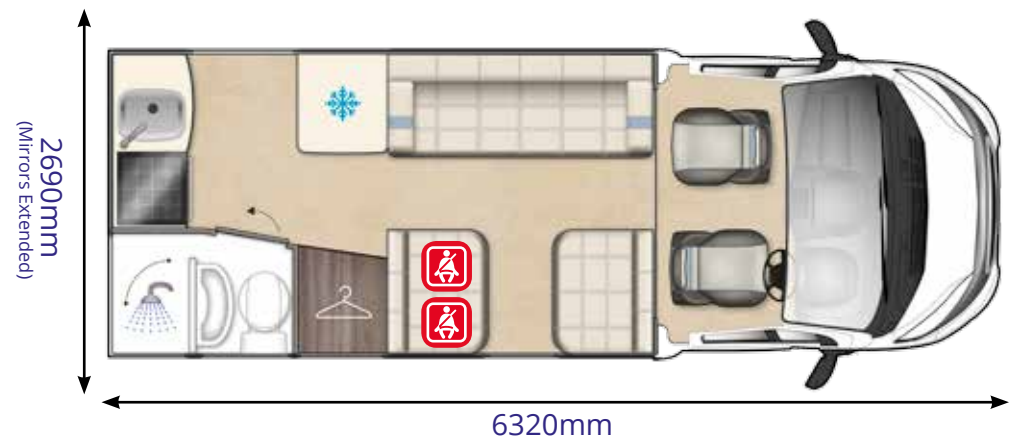



Sleeping Options

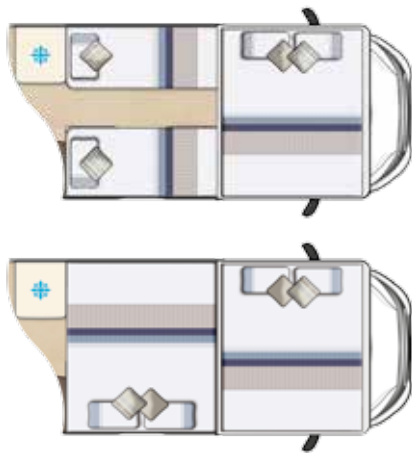

Key Features

- Family friendly, 2 rear travel seats & beds for up to 4 people
- 25 litre underfloor mounted LPG gas tank
- 80W solar panel*
- **Truma iNet Control Box**
- **Trackstar Leisure CAT6 Vehicle Tracker with 1 year free subscription**
- External skirt storage locker
- **GRP body with scratch & impact resistant platinum sides including GRP Rear Panel with Hella LED Lights**
- Hartal exterior door c/w sliding door flyscreen
- Opening skyview window (LP only)
- Panoramic wind-up roof-light
- Thule (Omnistor) canopy awning*
- Reversing camera with Bluetooth® feed to Caravan Club approved Garmin SAT NAV*
- Alloy wheels* with spare wheel & carrier
- Leather steering wheel and gear knob*
- External BBQ & 230v mains sockets
- Safe, fire extinguisher, crockery set & crystal glasses
- USB ports
- Turbo Diesel 160bhp Peugeot Euro 6 engine as standard
- Optional Fiat Ducato 130/150bhp Comfort-Matic Engine#

Specification

- Vehicle Height (incl TV aerial) - 3005mm
- MTPLM - 3500kg
- MIRO - 3081kg
- Maximum User Payload - 419kg
- Essential Habitation Equipment - 17kg
- Fresh Water Tank - 102ltrs
- Waste Water Tank - 71ltrs



Bed Sizes

- Front Double - 2100 x 1840mm/ 6' 11" x 6' 0"
- Nearside Single - 1930 x 680mm/ 6' 4" x 2' 3"
- Offside Single - 1840 x 930mm/ 6' 0" x 3' 1"

*Premium pack *Optional **Bumper only on Fiat Ducato chassis **New for 2018**



Classic French Bed



Broadway FB

Fixed French bed model on a 3500kg chassis which retains the absolute luxury Auto-Sleepers are renowned for. A generously proportioned front lounge blends through a fully featured kitchen into a luxurious feature bedroom. The FB also contains a spacious side washroom, which boasts a separate shower, all delivered across a flat level floor for full practicality.



Interior Layout

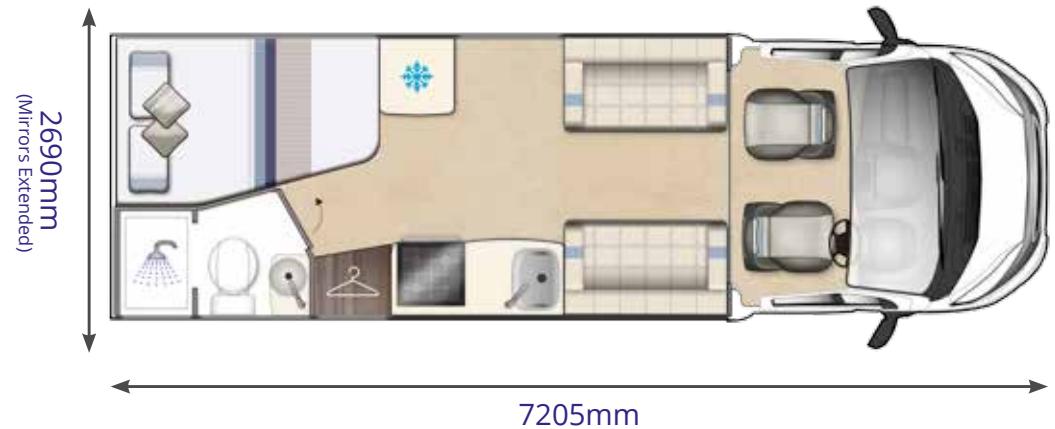



Sleeping Options



Key Features

- French bed, luxury kitchen and separate shower
- 25 litre underfloor mounted LPG gas tank
- 80W solar panel*
- **Truma iNet Control Box**
- **Trackstar Leisure CAT6 Vehicle Tracker with 1 year free subscription**
- External skirt storage locker
- **GRP body with scratch & impact resistant platinum sides including GRP Rear Panel with Hella LED Lights**
- Hartal exterior door c/w sliding door flyscreen
- Opening skyview window (LP only)
- Panoramic wind-up roof-light
- Thule (Omnistor) canopy awning*
- Reversing camera with Bluetooth® feed to Caravan Club approved Garmin SAT NAV*
- Alloy wheels* with spare wheel & carrier
- Leather steering wheel and gear knob*
- External BBQ & 230v mains sockets
- Safe, fire extinguisher, crockery set & crystal glasses
- USB ports
- Turbo Diesel 160bhp Peugeot Euro 6 engine as standard
- Optional Fiat Ducato 130/150bhp Comfort-Matic Engine#

Specification

- Vehicle Height (incl TV aerial) - 2930mm
- MTPLM - 3500kg
- MIRO - 3112kg
- Maximum User Payload - 388kg
- Essential Habitation Equipment - 25kg
- Fresh Water Tank - 102ltrs
- Waste Water Tank - 91ltrs



Bed Sizes

- Front Double - 2100 x 1220mm/ 6' 11" x 4' 0"
- Rear Double - 1940 x 1250mm/ 6' 4" x 4' 1"

*Premium pack *Optional **Bumper only on Fiat Ducato chassis **New for 2018**



The Specs >

Cutting Edge Engines

Auto-Sleepers 2018 Peugeot range motorhomes are fitted with Peugeot's BlueHDi 2.0L engines. BlueHDi is the name given to Peugeot's latest generation of fuel and environmentally efficient Diesel engines.

Generated from a world-famous diesel heritage and innovative, automotive engineering excellence, BlueHDi complies with Euro 6 emission standards to deliver a driving experience rich in power and performance but with exceptional fuel economy and CO2 emissions.

BlueHDi engines meet Euro 6 standards thanks to Selective Catalytic Reduction (SCR) and Particle Filtration processes. A three stage cleansing process specifically targets the pollutants of diesel combustion, removing hydrocarbons and carbon monoxide, reducing nitrogen oxides by up to 90% and eliminating 99.9% of particulates:

- **Stage One** - the oxidation catalytic converter eliminates the HC and the CO2, transforming them into water (H2O) and carbon dioxide (CO2)
- **Stage Two** - the SCR (Selective Catalytic Reduction) transforms the nitrogen oxides (NOx) into water and nitrogen (N2), which is the main constituent of air (78%), due to the addition of AdBlue® (mixture of urea and water)
- **Stage Three** - the Particulate Emission Filter eliminates 99.9% of the particulates by number

BlueHDi delivers the cleanest diesel engine possible and exceptional fuel economy specification and refinement.



Peace Of Mind On The Road

The standard safety features of the Auto-Sleepers 2018 Peugeot range include:

ESP - electronic stability program, ABS - Anti-lock Braking System with EBA - Emergency Braking Assistance, EBF - Electronic Brake Force Distribution, disc brakes, passenger and driver's airbags, fuel supply safety cut off, driver's seat belt indicator and safety auto-reverse windows.



Underfloor Mounted LPG Tank

All 2018 Auto-Sleeper Peugeot Coachbuilts have a 25 litre underfloor mounted LPG gas tank installed, offering hassle free practicality with numerous benefits including -

- Readily available from 1000's of petrol stations throughout Great Britain and Europe.
- Convenience personified, refilling them is as easy as filling the fuel tank
- No heavy bottles to lift, carry or manhandle
- No middle of the night change overs required
- Economical to use at approximately half the cost of cylinders, cost per litre typically only 60p
- Interior space saving, the tank is externally mounted to the underside of the Motorhome
- Easy read LED tank gauge and an Auto-Stop feature to prevent any chance of overfilling
- Reliable and safety proven, extensively tested for peace of mind and fully approved under European Whole Vehicle Type Approval Legislation.



Cab Features



Bluetooth® Connectivity & Steering Wheel Controls

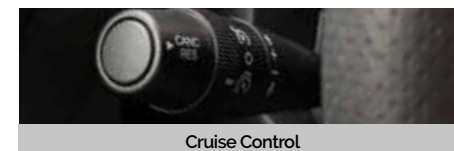

Cruise Control



Cab Air Conditioning



Digital DAB radio with Bluetooth®



6 Speed Manual Gearbox

Base Vehicle Specification Exterior General

- Turbo Diesel 160bhp Euro 6 manual engine
- Optional Fiat Ducato 130/150bhp Comfort-Matic Engine*
- **Trackstar Leisure CAT6 Vehicle Tracker with 1 year free subscription**
- ESP, ABS brakes with EBA, EBFDF as standard
- Alloy wheels* plus spare wheel & carrier
- Cruise control*
- Cab air conditioning*
- Colour co-ordinated front bumper and door handles**
- Leather steering wheel and gear knob*
- Battery isolator on ignition
- Bluetooth® connectivity & steering wheel controls
- Digital DAB radio with Bluetooth® connectivity
- USB and Auxiliary input sockets
- Gloss black dashboard fascia
- Power assisted steering
- Single key central locking for cab and habitation door
- Driver and passenger airbags
- Driver and passenger seat armrest
- Tyre pressure sensors
- Wing mirror aerials
- Electrically heated and adjustable door mirrors
- LED daytime running lights
- Electric cab windows
- 12v socket
- UV filtering tinted glass
- Rear fog lights
- Front fog lights*

Interior General

- Space saving under-floor 25 litre LPG gas tank with LED level indicator
- Hartal exterior door c/w sliding door flyscreen & central locking
- **Full scratch and impact resistant GRP body with platinum sides including GRP Rear Panel with Hella LED Lights**
- Opening wind-up sky-view window**
- Aluminium skirts
- Large external skirt locker (space saving under-floor mounted)
- Drop down access door to nearside seating
- Thule (Omnistor) roof mounted canopy awning*
- Reversing camera with Bluetooth® feed to Caravan Club approved Garmin SAT NAV*
- 80W solar panel*
- LED strip awning light
- Colour co-ordinated external TV socket
- Colour co-ordinated external gas BBQ point
- Colour co-ordinated external 230v mains socket
- Double-glazed opening windows with concertina blinds & flyscreens
- Multi directional TV aerial
- Electric slide-out entrance step with auto retract on engine start
- Rear mud-flaps
- Rear corner steadies
- Luxurious Valencia or Amarti furniture with chrome fixtures and fittings
- Panoramic wind-up opening rooflight
- Chrome grab handle with LED lights
- Privacy blinds & flyscreens to all opening windows
- Choice of Designer 'Catalan', 'Casa Milà' or 'Sagrada' fabrics providing luxurious interior soft furnishings
- High quality Reflex™ foam upholstery
- Colour co-ordinated habitation curtains with tiebacks and scatter cushions
- Removable interior carpets
- LED spotlights and roof lighting with a power saving of up to 70%
- Over locker LED mood lighting
- Seat tops on gas struts and drop down access door to the under seat storage space (model specific)
- Swivel cab seats on all front lounge models
- Over-cab storage compartments
- Spacious wardrobe
- Range of high & low-level storage lockers
- Cocktail cabinet with crystal wine glasses
- Freestanding table
- Foot-well entry step with AS logo light
- Smoke and carbon monoxide alarms
- Fire extinguisher

UPGRADES

Premium Pack

- Alloy wheels
- Cab air conditioning
- Cruise control
- Thule (Omnistor) canopy awning
- Colour reversing camera and Garmin SAT NAV
- Leather steering wheel and gear knob
- 80W solar panel

Winter Pack

- Concertina cab blinds in lieu of cab curtains
- Fresh & waste water tank heater blanket
- Truma Combi heater upgrade
- Wheel arch insulation blankets

Media Pack

- Maxview VuQube II Automatic Satellite System
 - Twin LNB to support 2 receivers
 - Fully Automatic Tuning
 - Receives transmissions from Astra 1, Astra 2, Astra 3 and Hotbird
 - Compatible with any SD/HD Free to air satellite receivers

Electrics and Plumbing

- LCD control panel
- Split charged leisure battery
- Four 230v sockets
- Two 12v sockets
- Truma dual fuel combi blown air central heating and water heater
- Truma Comfort air-conditioning#
- **Truma iNet Control Box**
- 102 Litre fresh water tank
- 71 Litre waste water tank
- Large bore waste pipework for efficient drainage
- Whale or Truma auto-fill & separate manual filler for fresh water tank
- Drive Safe Regulator

Kitchen

- Spacious and fully equipped with large slide out additional work surface
- Dual fuel hob with 3 gas burners and an electric hot plate plus separate oven and grill
- Dual level microwave oven
- Large refrigerator with freezer compartment
- Motique kitchen splashback
- Kitchen centre sink incorporating draining board and cutlery drying rack
- 12v extractor fan with down-lighters
- Cutlery drawer
- Kitchen roll holder
- Waste bin
- Melamine crockery set & cooler bag

Bathroom

- Combined shower and toilet compartment
- Swing wall showers with integrated washbasin
- Vanity cupboard with mirrors
- Separate shower cubicle (Broadway EB and Broadway FB)
- Chrome fixtures and fittings
- Storage cupboard
- Electric flush cassette toilet with separate header tank (model specific)
- Anti slip shower mat
- Ducted blown air outlet
- LED lighting
- Retractable clothesline (model specific)
- Roof vent with flyscreen



Luxury Personified

Peugeot AL-KO Coachbuilts

Heritage and luxury with unrivalled finesse, nothing comes close to the all new Corinium: Three palatial layouts, AL-KO foundations and 2.35m body width for the ultimate touring experience...

Models

3

Min Berth

 **2**

Max. Berth

 **4**

What's Inside?

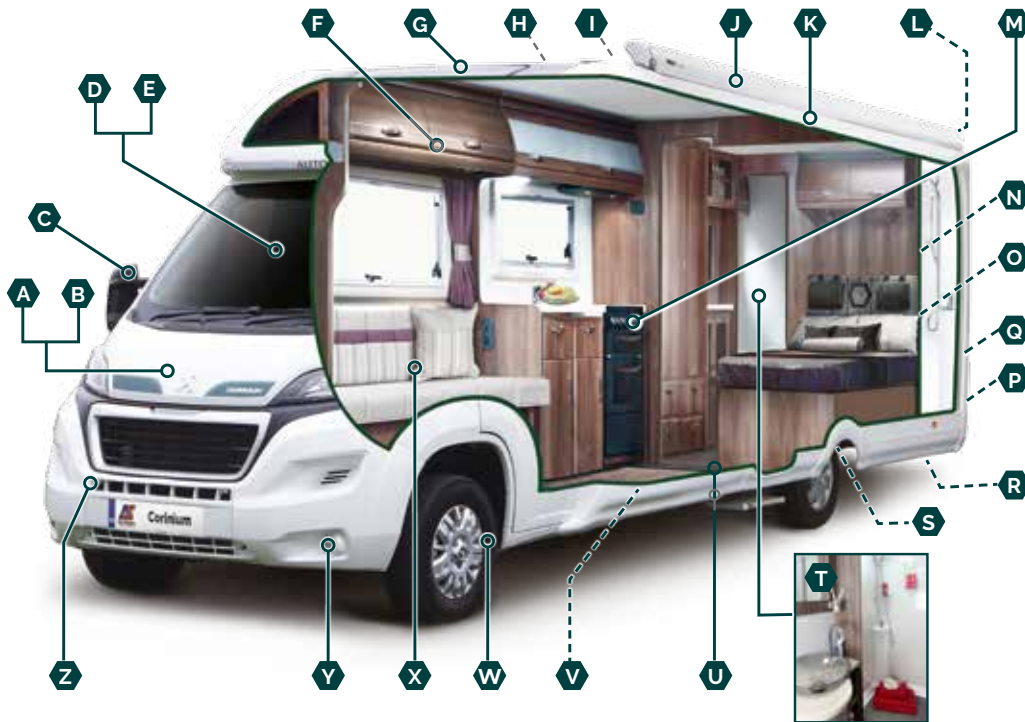

- A. 160bhp Peugeot Euro 6 engine
- B. Fiat Comfort-Matic 130/150bhp engine*
- C. Wing mirror aerial
- D. Cab air conditioning, cruise control*, digital DAB radio, Bluetooth®, passenger air-bag & Garmin Sat-Nav*
- E. **Truma iNet Control Box**
- F. Luxury Valencia furniture or Amarti furniture
- G. Wind-up opening skyview window & panoramic roof-light**
- H. **Trackstar Leisure CAT6 Vehicle Tracker with 1 year free subscription**
- I. 80W solar panel*
- J. Thule (Omnistor) canopy awning*
- K. **Full scratch and impact resistant GRP body with platinum sides including GRP Rear Panel with Hella LED Lights**
- L. Full spectrum reversing camera*
- M. Fully featured kitchens
- N. Safe, fire extinguisher, crockery set & crystal glasses
- O. Hartal exterior door c/w sliding door flyscreen
- P. External BBQ & 230v mains socket
- Q. Rear corner steadies
- R. Spare wheel and carrier with a remote tyre pressure valve
- S. Rear mud flaps
- T. Spacious en-suite washroom facilities
- U. Large skirt storage locker, underfloor mounted for space saving
- V. 25 litre under-floor mounted LPG gas tank
- W. Alloy wheels*
- X. Designer 'Catalan', 'Casa Milà' & 'Sagrada' fabric options
- Y. Front fog lights#
- Z. Colour coded bumpers

Key Features



160bhp Peugeot Euro Engine

Drive with confidence, the 2018 Auto-Sleepers Peugeot range features powerful 160bhp engines as standard.

Optional 130/150bhp Fiat Comfort-matic

Optional Fiat Ducato 130bhp or 150bhp Comfort-matic gearbox available on all Auto-Sleeper 2018 Peugeot models.



Media Pack

Enjoy entertainment on the move with the 2018 range of Peugeot AL-KO coachbuilts. The corinium range comes with the Media Pack upgrade as standard



Grade 3 Fully Insulated

All our Peugeot AL-KO coachbuilts feature Grade III Classification for heating and thermal insulation.



80W Solar Panel

Be more self-sufficient and save money on your next holiday thanks to the included Solar Panel.



Underfloor Mounted LPG Tank

25 litre underfloor mounted LPG gas tank installed, offering hassle free practicality with numerous benefits

*Premium Pack **Low Profile roof only #Optional **New for 2018**



Aspirational Decadence



Corinium FB

The Corinium FB offers aspirational decadence for the discerning owner looking for the space and comfort normally associated with a tag axle Motorhome, but crucially on an economically lighter AL-KO chassis. The front provides a spacious lounge with a fully featured kitchen leading into a spacious rear bedroom with a full width en-suite washroom.



Interior Layout





Sleeping Options



Key Features

- 3500kg MTPLM AL-KO wide track chassis
- Optional 4000kg chassis upgrade*
- 25 litre underfloor mounted LPG gas tank
- 80W solar panel*
- External skirt storage locker
- **GRP body with scratch & impact resistant platinum sides including GRP Rear Panel with Hella LED Lights**
- **Truma iNet Control Box**
- **Trackstar Leisure Vehicle Tracker**
- Hartal exterior door c/w sliding door flyscreen
- Opening skyview window
- Panoramic wind-up roof-light
- Thule (Omnistor) canopy awning*
- Reversing camera with Bluetooth® feed to Caravan Club approved Garmin SAT NAV**
- Alloy wheels*
- Fix and go emergency repair kit on light chassis
- Optional Spare wheel and carrier on light chassis*
- Spare wheel standard on heavy chassis
- Leather steering wheel and gear knob*
- External BBQ & 230v mains sockets
- USB ports
- Turbo Diesel 160bhp Peugeot Euro 6 engine as standard
- Optional Fiat Ducato 130/150bhp Comfort-Matic Engine*

Specification

- Vehicle Height (incl TV aerial) - 2900mm
- Optional MTPLM Upgrade to 4000kg
- MTPLM - 3500kg/ 4000kg
- MIRO** - 3207kg
- Maximum User Payload - 293kg/ 708kg
- Essential Habitation Equipment - 17kg
- Fresh Water Tank - 91ltrs
- Waste Water Tank - 71ltrs



Bed Sizes

- Front Double - 2210x1220mm 7'3"x4'0"
- Rear Double - 1860 x 1300mm 6'1" x 4'3"

*Premium Pack **No Spare Wheel *Optional **New for 2018**



Single Bed Luxury



Corinium Duo

For those interested in supreme luxury combined with single bed functionality, look no further than **The Corinium Duo**. Following on from the FB model, the Duo provides space and comfort normally associated with a tag axle Motorhome, but crucially on an economically lighter AL-KO chassis. The front provides a spacious lounge with a fully featured kitchen leading into a true flagship of a rear bedroom with spacious single beds and a full width en-suite washroom



Interior Layout

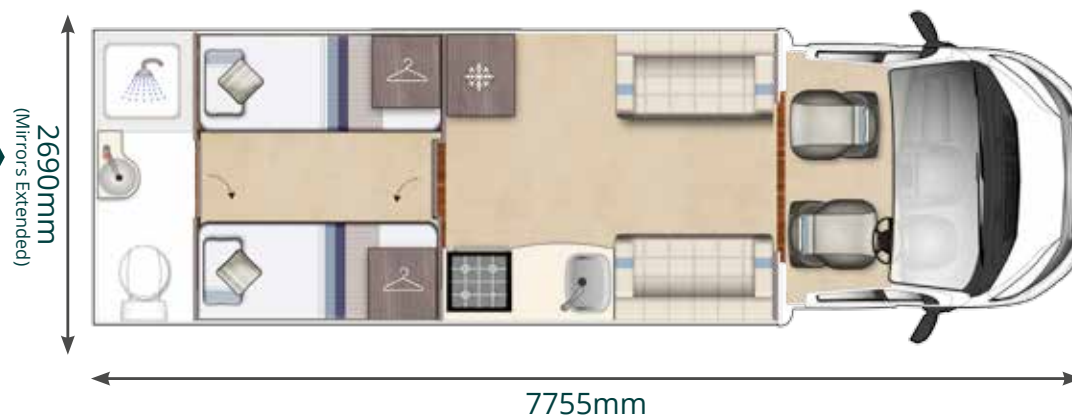



Sleeping Options



Key Features

- 3500kg MTPLM AL-KO wide track chassis
- Optional 4000kg chassis upgrade*
- 25 litre underfloor mounted LPG gas tank
- 80W solar panel*
- External skirt storage locker
- **GRP body with scratch & impact resistant platinum sides including GRP Rear Panel with Hella LED Lights**
- **Truma iNet Control Box**
- **Trackstar Leisure Vehicle Tracker**
- Hartal exterior door c/w sliding door flyscreen
- Opening skyview window
- Panoramic wind-up roof-light
- Thule (Omnistor) canopy awning*
- Reversing camera with Bluetooth® feed to Caravan Club approved Garmin SAT NAV*
- Alloy wheels*
- Fix and go emergency repair kit on light chassis
- Optional Spare wheel and carrier on light chassis*
- Spare wheel standard on heavy chassis
- Leather steering wheel and gear knob*
- External BBQ & 230v mains sockets
- USB ports
- Turbo Diesel 160bhp Peugeot Euro 6 engine as standard
- Optional Fiat Ducato 130/150bhp Comfort-Matic Engine*

Specification

- Vehicle Height (incl TV aerial) - 2900mm
- Optional MTPLM Upgrade to 4000kg
- MTPLM - 3500kg/ 4000kg
- MIRO** - 3137kg
- Maximum User Payload - 363kg/ 779kg
- Essential Habitation Equipment - 17kg
- Fresh Water Tank - 91ltrs
- Waste Water Tank - 71ltrs



Bed Sizes

- Front Double - 2210x1220mm 7'3"x4'0"
- Nearside Single - 1860 x 780mm 6'1" x 2'7"
- Offside Single - 1860 x 780mm 6'1" x 2'7"

*Premium Pack **No Spare Wheel *Optional **New for 2018**



Home from Home Luxury



Corinium RB

The Corinium RB's arrangement of onboard facilities provides a spacious and functional layout which combined with the comfort of the luxurious rear island bed creates a true home-away from home experience. The front provides a spacious lounge with fully featured kitchen and washroom areas which lead onto the grand rear bedroom. All of this of course is built on an economically light AL-KO chassis.



Interior Layout

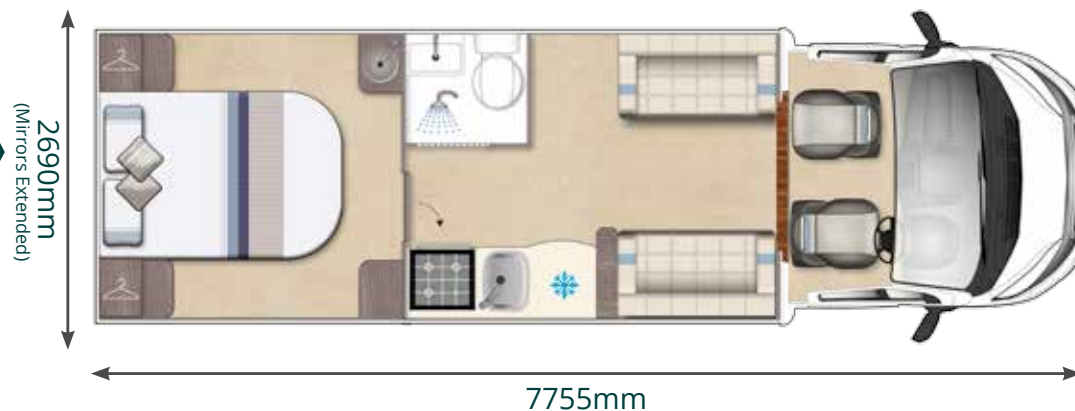



PEUGEOT ALKO COACHBUILTS

Sleeping Options



Key Features

- 3500kg MTPLM AL-KO wide track chassis
- Optional 4000kg chassis upgrade*
- 25 litre underfloor mounted LPG gas tank
- 80W solar panel*
- External skirt storage locker
- **GRP body with scratch & impact resistant platinum sides including GRP Rear Panel with Hella LED Lights**
- **Truma iNet Control Box**
- **Trackstar Leisure Vehicle Tracker**
- Hartal exterior door c/w sliding door flyscreen
- Opening skyview window
- Panoramic wind-up roof-light
- Thule (Omnistor) canopy awning*
- Reversing camera with Bluetooth® feed to Caravan Club approved Garmin SAT NAV*
- Alloy wheels*
- Fix and go emergency repair kit on light chassis
- Optional Spare wheel and carrier on light chassis*
- Spare wheel standard on heavy chassis
- Leather steering wheel and gear knob*
- External BBQ & 230v mains sockets
- USB ports
- Turbo Diesel 160bhp Peugeot Euro 6 engine as standard
- Optional Fiat Ducato 130/150bhp Comfort-Matic Engine*

Specification

- Vehicle Height (incl TV aerial) - 2900mm
- Optional MTPLM Upgrade to 4000kg
- MTPLM - 3500kg/ 4000kg
- MIRO** - 3237kg
- Maximum User Payload - 263kg/ 678kg
- Essential Habitation Equipment - 17kg
- Fresh Water Tank - 91ltrs
- Waste Water Tank - 71ltrs



Bed Sizes

- Front Double - 2210x1220mm 7'3"x4'0"
- Rear Double - 1940x1220mm 6'4"x4'0"

*Premium Pack **No Spare Wheel *Optional **New for 2018**



WWW.AUTO-SLEEPERS.COM / PEUGEOT AL-KO COACHBUILTS / CORINIUM RB / 47

The Specs >

Cutting Edge Engines

Auto-Sleepers 2018 Peugeot range motorhomes are fitted with Peugeot's BlueHDi 2.0L engines. BlueHDi is the name given to Peugeot's latest generation of fuel and environmentally efficient Diesel engines.

Generated from a world-famous diesel heritage and innovative, automotive engineering excellence, BlueHDi complies with Euro 6 emission standards to deliver a driving experience rich in power and performance but with exceptional fuel economy and CO2 emissions.

BlueHDi engines meet Euro 6 standards thanks to Selective Catalytic Reduction (SCR) and Particle Filtration processes. A three stage cleansing process specifically targets the pollutants of diesel combustion, removing hydrocarbons and carbon monoxide, reducing nitrogen oxides by up to 90% and eliminating 99.9% of particulates:

- **Stage One** - the oxidation catalytic converter eliminates the HC and the CO2, transforming them into water (H2O) and carbon dioxide (CO2)
- **Stage Two** - the SCR (Selective Catalytic Reduction) transforms the nitrogen oxides (NOx) into water and nitrogen (N2), which is the main constituent of air (78%), due to the addition of AdBlue® (mixture of urea and water)
- **Stage Three** - the Particulate Emission Filter eliminates 99.9% of the particulates by number

BlueHDi delivers the cleanest diesel engine possible and exceptional fuel economy specification and refinement.



Peace Of Mind On The Road

The standard safety features of the Auto-Sleepers 2018 Peugeot range include:

ESP - electronic stability program, ABS - Anti-lock Braking System with EBA - Emergency Braking Assistance, EBFD - Electronic Brake Force Distribution, disc brakes, passenger and driver's airbags, fuel supply safety cut off, driver's seat belt indicator and safety auto-reverse windows.



AL-KO Foundations

Since 1979, AL-KO has been at the forefront of motorhome chassis conversions. AL-KO has worked to engineer a lightweight, low height chassis perfectly suited for motorhome use.

AMC chassis are specially engineered to provide the maximum strength and stability within the lightest possible frame.

This enables motorhome owners to take additional luggage, but also provides the opportunity to carry heavier and larger leisure equipment.



Cab Features



Bluetooth® Connectivity & Steering Wheel Controls

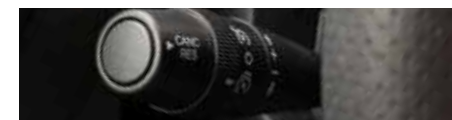

Cruise Control



Cab Air Conditioning



Digital DAB radio with Bluetooth®



6 Speed Manual Gearbox

Base Vehicle Specification

- 3500kg MTPLM AL-KO wide track chassis
- Optional 4000kg chassis upgrade*
- Turbo Diesel 160bhp Euro 6 engine
- Optional Fiat Ducato 130/150bhp Comfort-Matic Engine#
- ESP, ABS brakes with EBA, EBFD as standard
- Alloy wheels*
- Fix and go emergency repair kit on light chassis
- Optional spare wheel & tyre on light chassis*
- Spare wheel standard on heavy chassis
- LED daytime running lights
- Cruise control*
- Cab air conditioning*
- Digital DAB radio with Bluetooth® connectivity
- **Trackstar Leisure CAT6 Vehicle Tracker with 1 year free subscription**
- Bluetooth® hands free connectivity and steering wheel controls
- USB and Auxiliary input sockets
- Gloss black dashboard fascia
- Leather steering wheel and gear knob*
- Battery Isolator on ignition
- Colour co-ordinated bumpers and door handle***
- Single key central locking for cab and habitation door
- Driver and passenger airbags
- Driver and passenger seat armrest
- Power assisted steering
- Wing mirror aerial
- Electrically heated and adjustable door mirrors
- Electric cab windows
- 12v socket
- UV filtering tinted glass
- Rear fog lights
- Front fog lights*

Exterior General

- Space saving under-floor 25 litre LPG gas tank with LED level indicator
- Hartal exterior door c/w sliding door flyscreen & central locking
- **Full scratch and impact resistant GRP body with platinum sides including GRP Rear Panel with Hella LED Lights**
- Opening wind-up sky-view window**
- Aluminium skirts
- Reversing camera with Bluetooth® feed to Caravan Club approved Garmin SAT NAV*
- 80W solar panel*
- Drop down access door to nearside seating
- Large external skirt locker (space saving under-floor mounted)
- Colour co-ordinated external TV socket
- Thule (Omnistor) roof mounted canopy awning*
- Colour co-ordinated external gas BBQ point
- LED strip awning light
- Colour co-ordinated external 230v mains socket
- Double-glazed opening windows with concertina blinds & flyscreens
- Electric slide-out entrance step with auto retract on engine start
- Rear corner steadies

Interior General

- Luxurious Valencia furniture with chrome fixtures and fittings
- Panoramic wind-up opening rooflight**
- Privacy blinds & flyscreens to all opening windows
- Choice of Designer 'Catalan', 'Casa Milà' or 'Sagrada' fabrics providing luxurious interior soft furnishings
- High quality Reflex™ foam upholstery
- Removable interior carpets
- Colour co-ordinated habitation curtains with tiebacks and scatter cushions
- LED spotlights and roof lighting with a power saving of up to 70%
- Over locker LED mood lighting
- Swivel cab seats
- Over-cab storage compartments
- Seat tops on gas struts and drop down access door to the under seat storage space (model specific)
- Spacious wardrobe
- Range of high & low-level storage lockers
- Cocktail cabinet with crystal wine glasses
- Freestanding table
- Foot-well entry step with AS logo light
- Smoke and carbon monoxide alarms
- Fire extinguisher

Electrics and Plumbing

- LCD control panel
- Split charged leisure battery
- Four 230v sockets
- Two 12v sockets
- Truma dual fuel combi blown air central heating and water heater
- Truma Comfort air-conditioning*
- **Truma iNet Control Box**
- 91 Litre fresh water tank
- 71 Litre waste water tank
- Large bore waste pipework for efficient drainage
- Whale or Truma auto-fill & separate manual filler for fresh water tank

Kitchen

- Spacious and fully equipped with large slide out additional work surface
- Motique splash back panel
- Dual fuel hob with 3 gas burners and an electric hot plate plus separate oven and grill
- Dual level microwave oven
- Cutlery drawer
- Large refrigerator with freezer compartment
- 12v extractor fan with down-lighters
- Kitchen centre sink incorporating draining board and cutlery drying rack
- Kitchen roll holder & waste bin
- Melamine crockery set & cooler bag

Bathroom

- Combined shower and toilet compartment (RB only)
- Vanity cupboard with mirrors
- Separate shower cubicle (FB & Duo models)
- Electric flush cassette toilet with separate header tank
- Chrome fixtures and fittings
- Storage cupboard
- Anti slip shower mat
- Ducted blown air outlet
- LED lighting
- Roof vent with flyscreen

UPGRADES

Premium Pack

- Alloy wheels
- Cab air conditioning
- Cruise control
- Leather steering wheel and gear knob
- 80W solar panel
- Thule (Omnistor) canopy awning
- Colour reversing camera and Garmin SAT NAV

Chassis Options



Winter Pack

- Concertina cab blinds in lieu of cab curtains
- Fresh & waste water tank heater blanket
- Truma Combi heater upgrade
- Wheel arch insulation blankets

Media Pack (Delete Option)

- Maxview VuQube II Automatic Satellite System
- Twin LNB to support 2 receivers
- Fully Automatic Tuning
- Receives transmissions from Astra 1, Astra 2, Astra 3 and Hotbird
- Compatible with any SD/HD Free to air satellite receivers



*Premium pack **Fixed bed Models only #Optional **New for 2018**



WWW.AUTO-SLEEPERS.COM / PEUGEOT AL-KO COACHBUILTS / SPECIFICATION / 49



Ultimate Luxury

Mercedes Coachbuilts

Lavish styling combined with exceptional specification and unrivalled driving performance all built on the Mercedes motorhome chassis for the ultimate in touring luxury. All Mercedes Coachbuilts come with the option of having the best fully automatic gearbox available on a motorhome.

Models

6

Min Berth

 2

Max. Berth

 4

What's Inside?

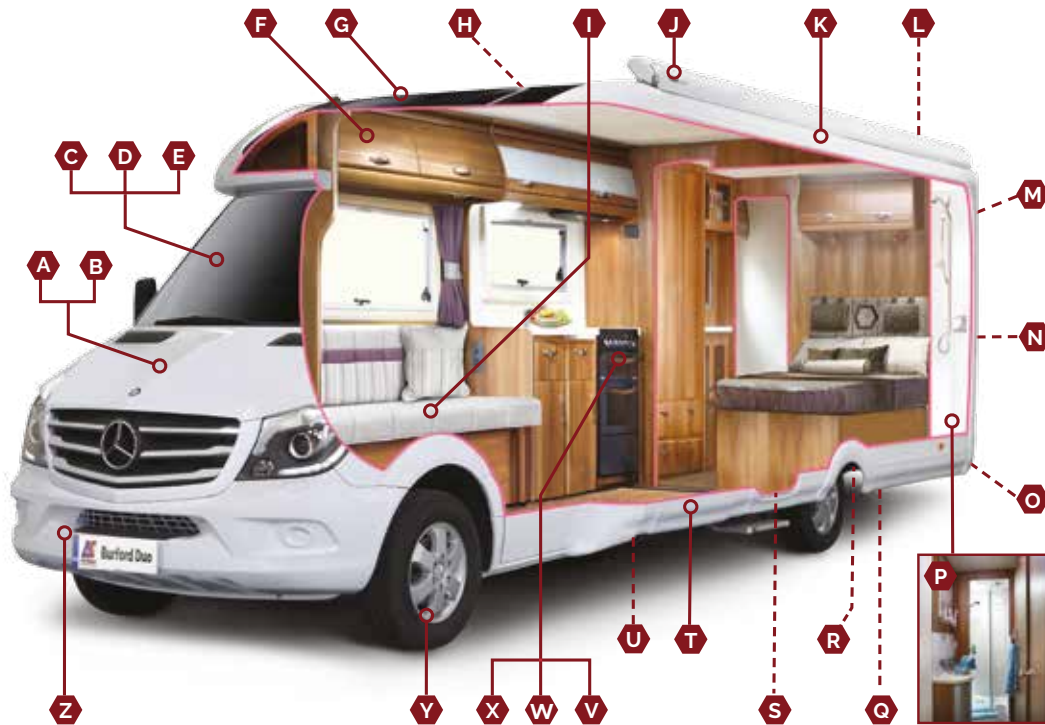

- A. Full Mercedes-Benz electrics package: ESP with Active Skid Control & ABS with EBD
- B. Fully automatic 7-speed gearbox*
- C. Cab air conditioning & cruise control*
- D. **Truma iNet Control Box**
- E. **Trackstar Leisure CAT6 Vehicle Tracker with 1 year free subscription**
- F. Luxury Valencia or Amarti furniture
- G. Wind-up opening skyview window & panoramic roof-light**
- H. 80W solar panel*
- I. Designer Catalan, 'Casa Milà' & 'Sagrada' fabric options
- J. Thule (Omniistor) canopy awning (up to 5m)*
- K. **Full scratch and impact resistant GRP body with platinum sides including GRP Rear Panel with Hella LED Lights**
- L. **Truma Aventa Comfort air-conditioning**
- M. Full spectrum reversing camera*
- N. External BBQ & 230v mains socket
- O. Rear corner steadies
- P. Spacious en-suite washroom facilities
- Q. Spare wheel and carrier with a remote tyre pressure valve#
- R. Rear mud-flaps
- S. Hartal entrance door c/w sliding door flyscreen
- T. Large skirt storage locker, underfloor mounted for space saving
- U. 25 litre under-floor mounted LPG gas tank
- V. Fully featured kitchens
- W. Drive safe regulator
- X. Crockery set & crystal glasses
- Y. Alloy wheels*
- Z. Colour coded bumpers

Key Features



163bhp Mercedes Euro Engine

Drive with confidence, the 2018 Mercedes coachbuilt range features powerful 163bhp engines as standard.

Fully automatic 7-speed gearbox*

Mercedes coachbuilt models can be fitted with Mercedes' latest 7-speed automatic gearbox as part of the premium pack upgrade.



More comfort on the move

Truma Aventa Comfort

Enjoy a pleasant indoor climate thanks to the Truma Aventa Comfort roof-mounted air conditioning system.



Grade 3 Fully Insulated

All our Mercedes coachbuilts feature Grade III Classification for heating and thermal insulation.



80W Solar Panel

Be more self-sufficient and save money on your next holiday thanks to the included Solar Panel.



Underfloor Mounted LPG Tank

25 litre underfloor mounted LPG gas tank installed, offering hassle free practicality with numerous benefits

Powerful & Compact



Stanton

The Stanton is our most compact model built on the Mercedes rear wheel drive chassis and belies the space available inside along with the flagship specification levels including an optional fully automatic gearbox. The Stanton truly is the king of all Compact Motorhomes, offering everything that one could possibly want or need whilst the Mercedes offers unprecedented driving comfort and is full of innovative features that are sure to make even the longest journey a breeze.



Interior Layout

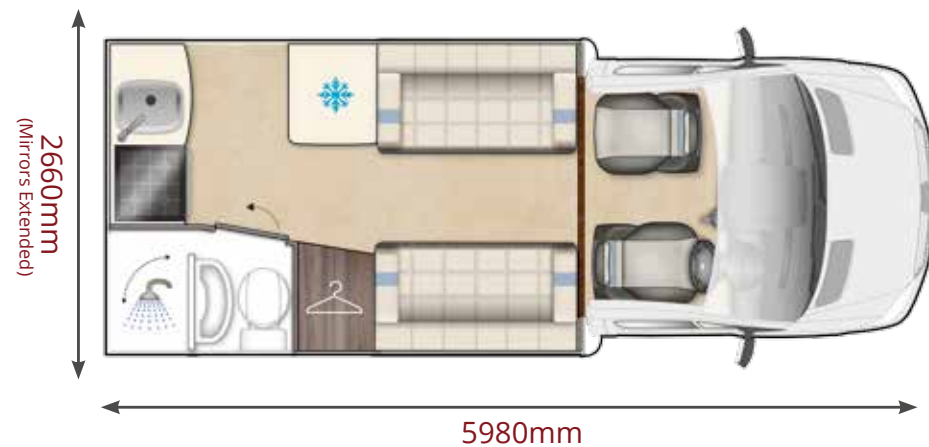



Sleeping Options

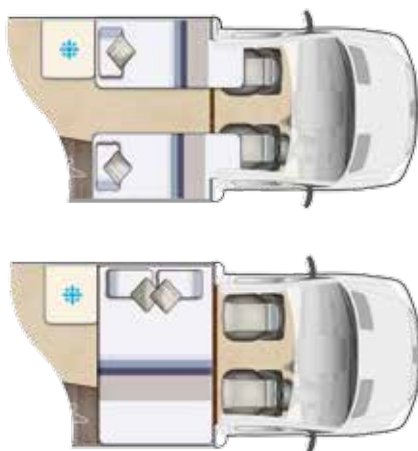

Key Features

- Iconic model under 6m with single beds and end kitchen
- Turbo diesel 163bhp engine
- Optional 7-speed fully automatic gearbox*
- **Truma iNet Control Box**
- **Trackstar Leisure Vehicle Tracker**
- **Truma Aventa Comfort air-conditioning**
- 25 litre underfloor mounted LPG gas tank
- Hartal exterior door c/w sliding door flyscreen
- Full Mercedes electrics package: ESP with active skid control & ABS with EBD
- 80W solar panel*
- External skirt storage locker
- **GRP body with scratch & impact resistant platinum sides including GRP Rear Panel with Hella LED Lights**
- Opening wind-up skyview window
- Panoramic wind-up roof-light
- Thule (Omnistor) canopy awning*
- Reversing camera with Bluetooth® feed to Caravan Club approved Garmin SAT NAV*
- Alloy wheels*
- External BBQ & 230v mains sockets
- Safe, fire extinguisher, crockery set & crystal glasses

Specification

- Vehicle Height (incl TV aerial) - 2850mm
- Optional MTPLM Upgrade to 3500kg
- MTPLM - 3200kg/ 3500kg
- MIRO - 2849kg
- Maximum User Payload - 351kg/ 651kg
- Essential Habitation Equipment - 17kg
- Fresh Water Tank - 71ltrs
- Waste Water Tank - 53ltrs



Bed Sizes

- Front Double - 2100 x 1400mm/ 6' 11" x 4' 7"
- Nearside Single - 1930 x 700mm/ 6' 4" x 2' 4"
- Offside Single - 1930 x 700mm/ 6' 4" x 2' 4"

*Premium Pack #Optional **New for 2018**



Quintessential Luxury



Bourton

The Bourton builds on the popularity of the Stanton to deliver a spacious model that does not compromise on its front lounge end kitchen layout. The Bourton has an extraordinarily spacious lounge quickly converts into either full-length singles or a truly palatial double bed. The Mercedes chassis is renowned for its driving comfort and the optional fully automatic gearbox makes it the perfect base vehicle for a luxuriously specified flagship range.



Interior Layout

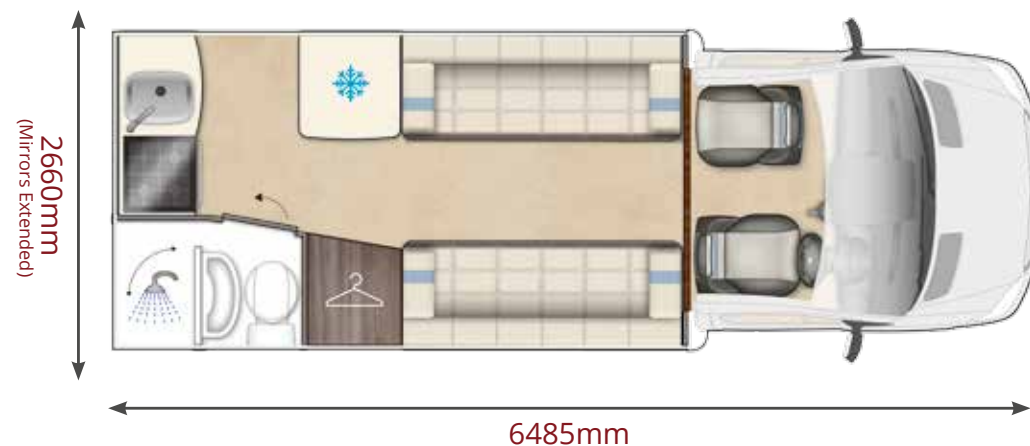



Sleeping Options

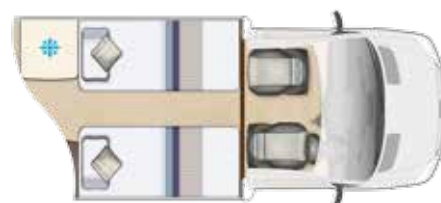
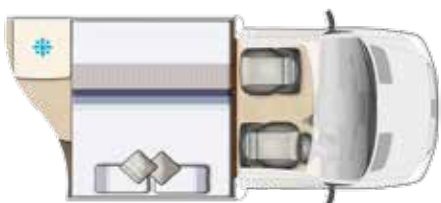

Key Features

- Full single beds, swingwall washroom, end kitchen
- Turbo diesel 163bhp engine
- Optional 7-speed fully automatic gearbox*
- **Truma iNet Control Box**
- **Trackstar Leisure Vehicle Tracker**
- **Truma Aventa Comfort air-conditioning**
- 25 litre underfloor mounted LPG gas tank
- Hartal exterior door c/w sliding door flyscreen
- Full Mercedes electrics package: ESP with active skid control & ABS with EBD
- 80W solar panel*
- External skirt storage locker
- **GRP body with scratch & impact resistant platinum sides including GRP Rear Panel with Hella LED Lights**
- Opening wind-up skyview window
- Panoramic wind-up roof-light
- Thule (Omnistor) canopy awning*
- Reversing camera with Bluetooth® feed to Caravan Club approved Garmin SAT NAV*
- Alloy wheels*
- External BBQ & 230v mains sockets
- Safe, fire extinguisher, crockery set & crystal glasses

Specification

- Vehicle Height (incl TV aerial) - 2860mm
- MTPLM - 3500kg
- MIRO - 2983kg
- Maximum User Payload - 517kg
- Essential Habitation Equipment - 17kg
- Fresh Water Tank - 62ltrs
- Waste Water Tank - 53ltrs



Bed Sizes

- Front Double - 2100 x 1920mm/ 6' 11" x 6' 4"
- Nearside Single - 1920 x 730mm/ 6' 4" x 2' 5"
- Offside Single - 1920 x 730mm/ 6' 4" x 2' 5"

*Premium Pack #Optional **New for 2018**



Award Winning Classic



Winchcombe

Luxury personified befits the Winchcombe which delivers the perfectly proportioned 2-berth motorhome with its capacious front lounge, top of the range centre kitchen and luxurious end washroom which boasts a double shower. With a specification that is truly second to none, befitting its flagship status, the Mercedes chassis adds the final touch to refined touring at its best.



Interior Layout

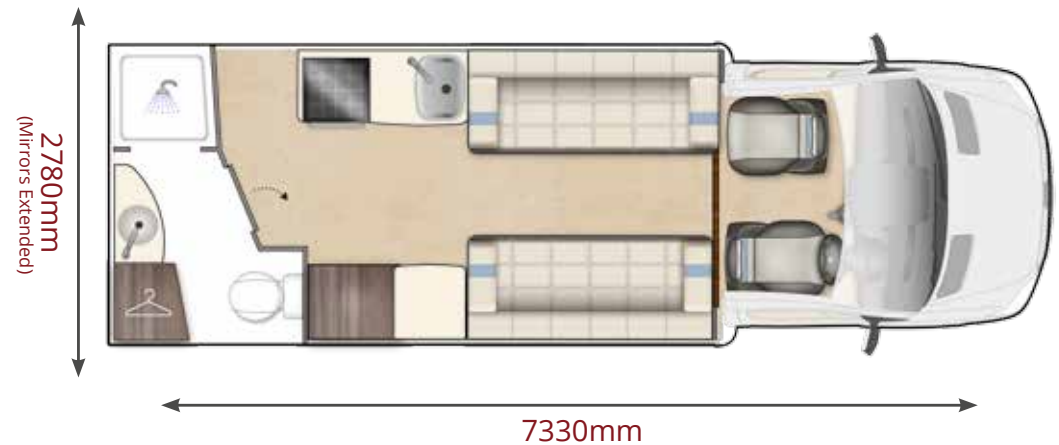



Sleeping Options

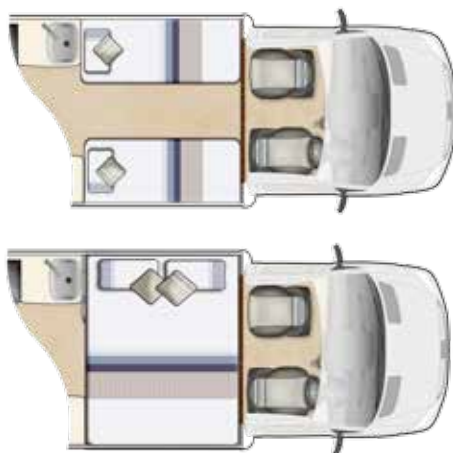

Key Features

- Superb end washroom and feature kitchen
- Turbo diesel 163bhp engine
- Optional 7-speed fully automatic gearbox*
- **Truma iNet Control Box**
- **Trackstar Leisure Vehicle Tracker**
- **Truma Aventa Comfort air-conditioning**
- 25 litre underfloor mounted LPG gas tank
- Hartal exterior door c/w sliding door flyscreen
- Full Mercedes electrics package: ESP with active skid control & ABS with EBD
- 80W solar panel*
- External skirt storage locker
- **GRP body with scratch & impact resistant platinum sides including GRP Rear Panel with Hella LED Lights**
- Opening wind-up skyview window
- Panoramic wind-up roof-light
- Thule (Omnistor) canopy awning*
- Reversing camera with Bluetooth® feed to Caravan Club approved Garmin SAT NAV*
- Alloy wheels*
- External BBQ & 230v mains sockets
- Safe, fire extinguisher, crockery set & crystal glasses

Specification

- Vehicle Height (incl TV aerial) - 2860mm
- MTPLM - 3880kg
- MIRO - 3238kg
- Maximum User Payload - 642kg
- Essential Habitation Equipment - 25kg
- Fresh Water Tank - 91ltrs
- Waste Water Tank - 71ltrs

Bed Sizes

- Front Double - 2100 x 1270mm/ 7' 3" x 4' 0"
- Nearside Single - 1940 x 700mm/ 6' 4" x 2' 4"
- Offside Single - 1900 x 700mm/ 6' 3" x 2' 4"



*Premium Pack #Optional **New for 2018**



Traditional French Bed



Malvern

The Malvern combines the absolute comfort of the fixed French bed and the stylish luxury that Auto-Sleeper are renowned for. This practical layout offers a liberally proportioned front lounge, which easily converts into a large double bed. The Malvern also comes equipped with a fully appointed kitchen that is perfect for entertaining friends and family alike. The piece-de-resistance of the Malvern is the luxurious bedroom with a spacious side washroom which boasts a large separate shower.



Interior Layout

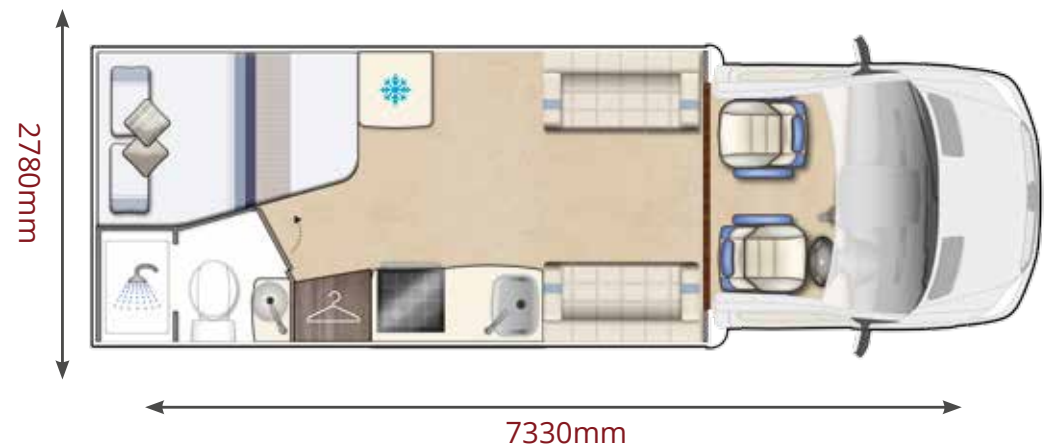



Sleeping Options

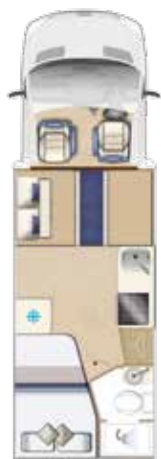

Key Features

- French bed, luxury kitchen and separate shower
- Turbo diesel 163bhp engine
- Optional 7-speed fully automatic gearbox*
- **Truma iNet Control Box**
- **Trackstar Leisure Vehicle Tracker**
- **Truma Aventa Comfort air-conditioning**
- 25 litre underfloor mounted LPG gas tank
- Hartal exterior door c/w sliding door flyscreen
- Full Mercedes electrics package: ESP with active skid control & ABS with EBD
- 80W solar panel*
- External skirt storage locker
- **GRP body with scratch & impact resistant platinum sides including GRP Rear Panel with Hella LED Lights**
- Opening wind-up skyview window
- Panoramic wind-up roof-light
- Thule (Omnistor) canopy awning*
- Reversing camera with Bluetooth® feed to Caravan Club approved Garmin SAT NAV*
- Alloy wheels*
- External BBQ & 230v mains sockets
- Safe, fire extinguisher, crockery set & crystal glasses

Specification

- Vehicle Height (incl TV aerial) - 2860mm
- MTPLM - 3880kg
- MIRO - 3221kg
- Maximum User Payload - 659kg
- Essential Habitation Equipment - 17kg
- Fresh Water Tank - 91ltrs
- Waste Water Tank - 78ltrs



Bed Sizes

- Front Double - 2210 x 1220mm/ 7' 3" x 4' 0"
- Rear Double - 1980 x 1370mm/ 6' 6" x 4' 6"

*Premium Pack #Optional **New for 2018**



Fixed Bed Ensuite



Burford

The Burford offers aspirational decadence for the discerning owner looking for the space and comfort normally associated with a tag axle Motorhome but crucially on an economically lighter rear wheel drive single axle Mercedes chassis. The front provides a spacious lounge with a fully featured kitchen leading into a spacious rear bedroom with a full width en-suite washroom. The Mercedes offers unprecedented driving comfort and is feature packed with computerised driving aids ensuring that even the longest journey is a pleasure.



Interior Layout





Sleeping Options



Key Features

- Single axle, french bed with large rear washroom
- Turbo diesel 163bhp engine
- Optional 7-speed fully automatic gearbox*
- **Truma iNet Control Box**
- **Trackstar Leisure Vehicle Tracker**
- **Truma Aventa Comfort air-conditioning**
- 25 litre underfloor mounted LPG gas tank
- Hartal exterior door c/w sliding door flyscreen
- Full Mercedes electrics package: ESP with active skid control & ABS with EBD
- 80W solar panel*
- External skirt storage locker
- **GRP body with scratch & impact resistant platinum sides including GRP Rear Panel with Hella LED Lights**
- Opening wind-up skyview window
- Panoramic wind-up roof-light
- Thule (Omnistor) canopy awning*
- Reversing camera with Bluetooth® feed to Caravan Club approved Garmin SAT NAV*
- Alloy wheels*
- External BBQ & 230v mains sockets
- Safe, fire extinguisher, crockery set & crystal glasses

Specification

- Vehicle Height (incl TV aerial) - 2880mm
- Optional MTPLM Upgrade to 4000kg
- MTPLM - 3880kg/4000kg
- MIRO - 3453kg
- Maximum User Payload -427kg/547kg
- Essential Habitation Equipment - 17kg
- Fresh Water Tank - 91ltrs
- Waste Water Tank - 91ltrs



Bed Sizes

- Front Double - 2210 x 1220mm/ 7' 3" x 4' 0"
- Rear Double - 1860 x 1300mm/ 6' 1" x 4' 3"

*Premium Pack #Optional **New for 2018**



Twin Bed Ensuite



Burford Duo

The Burford Duo offers aspirational decadence for the discerning owner looking for the space and comfort normally associated with a tag axle Motorhome but crucially on an economically lighter rear wheel drive single axle Mercedes chassis. The front provides a spacious lounge with a fully featured kitchen leading into a true flagship of a rear bedroom with spacious single beds and a full width ensuite washroom, whilst the Mercedes offers unprecedented driving comfort and is feature packed with computerised driving aids ensuring even the longest journey is a pleasure.



Interior Layout





Sleeping Options



Key Features

- Two fixed single beds with large rear washroom
- Turbo diesel 163bhp engine
- Optional 7-speed fully automatic gearbox*
- **Truma iNet Control Box**
- **Trackstar Leisure Vehicle Tracker**
- **Truma Aventa Comfort air-conditioning**
- 25 litre underfloor mounted LPG gas tank
- Hartal exterior door c/w sliding door flyscreen
- Full Mercedes electrics package: ESP with active skid control & ABS with EBD
- 80W solar panel*
- External skirt storage locker
- **GRP body with scratch & impact resistant platinum sides including GRP Rear Panel with Hella LED Lights**
- Opening wind-up skyview window
- Panoramic wind-up roof-light
- Thule (Omnistor) canopy awning*
- Reversing camera with Bluetooth® feed to Caravan Club approved Garmin SAT NAV*
- Alloy wheels*
- External BBQ & 230v mains sockets
- Safe, fire extinguisher, crockery set & crystal glasses

Specification

- Vehicle Height (incl TV aerial) - 2880mm
- Optional MTPLM Upgrade to 4000kg
- MTPLM - 3880kg/4000kg
- MIRO - 3383kg
- Maximum User Payload -497kg/617kg
- Essential Habitation Equipment - 17kg
- Fresh Water Tank - 91ltrs
- Waste Water Tank - 91ltrs



Bed Sizes

- Front Double - 2210 x 1220mm/ 7' 3" x 4' 0"
- Nearside Single - 1860 x 780mm/ 6' 1" x 2' 7"
- Offside Single - 1860 x 780mm/ 6' 1" x 2' 7"

*Premium Pack #Optional **New for 2018**



WWW.AUTO-SLEEPERS.COM / MERCEDES COACHBUILTS / BURFORD DUO / 63

The Specs >

The Best Sprinter Of All Time.

Outstanding Operational Reliability

The Auto-Sleepers Mercedes range is built on the latest generation Sprinter Chassis which lives up to the model's impressive reputation for outstanding operational reliability. The result of Mercedes continuous development process of ensures that the new Sprinter is even more advanced, even more flexible, even safer and even more economical.

Superb Technology

High quality standards and solid resale values all contribute to the overall cost-effectiveness of the Sprinter, as do its state-of-the-art engines

Your Safety Is Our Highest Priority.

The Mercedes Sprinter Chassis is the ultimate driver's chassis being supplied as standard with a vast array of electronic driving aids, all of which work in the background to make the journey as effortless and pleasurable as the destination.

Peace Of Mind On The Road

Innovative gas pressure regulator for safe single-cylinder operation. Installed as standard. See Page 75 for more details.



Underfloor Mounted LPG Tank

All 2018 Auto-Sleeper Mercedes Coachbuilts have a 25 litre underfloor mounted LPG gas tank installed, offering hassle free practicality with numerous benefits including -

- Readily available from 1000's of petrol stations throughout Great Britain and Europe.
- Convenience personified, refilling them is as easy as filling the fuel tank
- No heavy bottles to lift, carry or manhandle
- No middle of the night change overs required
- Economical to use at approximately half the cost of cylinders, cost per litre typically only 60p
- Interior space saving, the tank is externally mounted to the underside of the Motorhome
- Easy read LED tank gauge and an Auto-Stop feature to prevent any chance of overfilling
- Reliable and safety proven, extensively tested for peace of mind and fully approved under European Whole Vehicle Type Approval Legislation.



Safety Features As Standard



Electronic Stability Programme (ESP®)

The Mercedes-Benz ADAPTIVE ESP® is designed to assist the driver in maintaining control of the vehicle and intervene automatically when the vehicle detects a potential issue.

The load in a van is always altering, ADAPTIVE ESP® adapts to the load continually, moving with the centre of gravity as loads vary and adjusts to the specific load that is being carried. This system automatically detects when the vehicle is understeering or oversteering and intervenes to assist the driver to maintain control.



Acceleration skid control (ASR)

ASR ensures smooth start-off and acceleration, without wheel spin. As soon as one of the drive wheels starts to spin, ASR intervenes to reduce the engine power, and also by gently applying the brake to that wheel, to prevent a loss of traction. The result is improved traction - and safety - especially on slippery surfaces



Start-off Assist

Start-off Assist is fitted as standard to manual transmission models and means you don't have to juggle brake, clutch and handbrake when moving off on uphill or downhill slopes. Once the brake pedal has been released, the brake pressure is maintained for approximately two seconds, allowing you to move off without the vehicle rolling backwards.



Brake Assist (BAS)

Road and accident research has established even in an emergency, most drivers don't use the full power of the vehicle's brakes. This discovery led Mercedes-Benz to develop the Brake Assist system. By reacting to the speed at which the brake pedal is applied, Brake Assist can detect a situation where emergency braking is required. When that happens the system automatically increases braking power, aided by the anti-lock braking system (ABS) which prevents the wheels from locking up.

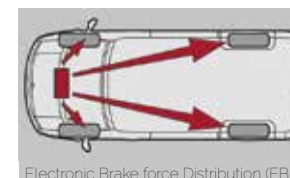

Electronic Brake force Distribution (EBD)

Electronic brake force distribution (EBD) divides up the braking force between the front and rear wheels of the motorhome as required, optimising braking efficiency in all driving situations. In this way the system prevents "overbraking" of the rear wheels, which could cause the vehicle to fishtail. EBD also puts less stress on the front brakes, which reduces the risk of fading due to overheating.



Anti-lock braking system (ABS)

The anti-lock braking system that comes as standard with the Mercedes Sprinter chassis features the latest in advanced technology. When the speed sensors detect that a wheel is on the point of locking up, the brake pressure at the wheel is immediately reduced, keeping the motorhome steerable even during emergency braking.

Base Vehicle Specification Exterior General

- Turbo diesel 163bhp engine
- Optional upgrade to V6 190bhp engine#
- Optional 7-speed fully automatic gearbox*
- **Trackstar Leisure Vehicle Tracker**
- Alloy wheels* plus spare wheel & carrier (except Stanton)
- Cruise control*
- Cab air conditioning*
- ESP with active skid control
- ABS brakes with EBD
- Cab alarm
- Audio 10 radio with Bluetooth® & SD card inputs
- Black high gloss dashboard fascia
- Colour co-ordinated bumpers
- Single key central locking for cab and habitation door
- Electrically heated and adjustable door mirrors
- Electric cab windows
- Rear fog light
- Lockable glove box
- 12v socket
- UV filtering tinted glass
- Driver and passenger airbags
- Driver and passenger seat armrest
- Power assisted steering



Exterior General

- Hartal exterior door c/w sliding door flyscreen & central locking
- 25 Litre underfloor mounted LPG gas tank
- Full GRP body including roof and rear panel
- **Full scratch and impact resistant GRP body with platinum sides including GRP Rear Panel with Hella LED Lights**
- Skyview wind-up opening rooflight**
- Aluminium skirts
- Large external skirt locker (under-floor mounted)
- Drop down access door to nearside seating
- Reversing camera with Bluetooth® feed to Caravan Club approved Garmin SAT NAV
- 80W solar panel*
- Thule (Omnistor) roof mounted canopy awning*
- LED strip awning light
- Colour co-ordinated external TV socket
- Colour co-ordinated external gas BBQ point
- Colour co-ordinated external 230v mains socket
- Double-glazed opening windows with concertina blinds & flyscreens
- Multi directional TV aerial
- Electric slide-out entrance step with auto retract on engine start
- Rear mud-flaps
- Rear corner steadies

Interior General

- Luxurious Valencia or Amarti furniture with chrome fixtures and fittings
- Panoramic wind-up opening rooflight**
- Privacy blinds & flyscreens to all opening windows
- Choice of Designer 'Catalan', 'Casa Milà' or 'Sagrada' fabrics providing luxurious interior soft furnishings
- High quality Reflex™ foam upholstery
- Colour co-ordinated habitation curtains with tiebacks and scatter cushions
- Chrome grab handle with LED lights
- Removable interior carpets
- LED spotlights and roof lighting with a power saving of up to 70%
- Over locker LED mood lighting
- Seat tops on gas struts and drop down access door to under-seat storage space (model specific)
- Swivel cab seats on all front lounge models
- Over-cab storage compartments
- Spacious wardrobe
- Range of high & low-level storage lockers
- Cocktail cabinet with crystal wine glasses
- Freestanding table
- Foot-well entry step with AS logo light
- Smoke and carbon monoxide alarms
- Fire extinguisher

UPGRADES

Premium Pack

- 7-Speed fully automatic gearbox
- Alloy wheels
- Cab air conditioning
- Cruise control
- Thule (Omnistor) canopy awning
- Colour reversing camera and Garmin SAT NAV
- 80W solar panel

Winter Pack

- Concertina cab blinds in lieu of cab curtains
- Fresh & waste water tank heater blanket
- Truma Combi heater upgrade
- Wheel arch insulation blankets

Media Pack

- Maxview VuQube II Automatic Satellite System
 - Twin LNB to support 2 receivers
 - Fully Automatic Tuning
 - Receives transmissions from Astra 1, Astra 2, Astra 3 and Hotbird
 - Compatible with any SD/HD Free to air satellite receivers

Electrics and Plumbing

- LCD control panel
- Split charged leisure battery
- Four 230v sockets
- Two 12v sockets
- Truma dual fuel combi blown air central heating and water heater
- **Truma iNet Control Box**
- **Truma Aventa Comfort air-conditioning**
- Large underslung fresh water tank (model specific)
- Large underslung waste water tank (model specific)
- Large bore waste pipework for efficient drainage
- Whale or Truma auto-fill & manual filler points for fresh water tank
- Drive Safe Regulator

Kitchen

- Spacious and fully equipped with large slide out additional work surface
- Dual fuel hob with 3 gas burners and an electric hot plate plus separate oven and grill
- Dual level microwave oven
- Cutlery drawer
- 12v extractor fan with down-lighters
- Motique kitchen splashback
- Large refrigerator with freezer compartment
- Kitchen centre sink incorporating draining board and cutlery drying rack
- Kitchen roll holder
- Waste bin
- Melamine crockery set & cooler bag

Bathroom

- Combined shower and toilet compartment
- Swing wall showers with integrated washbasin
- Vanity cupboard with mirrors
- Separate shower cubicle (Malvern, Winchcombe, Burford and Burford duo)
- Electric flush cassette toilet with separate header tank
- Chrome fixtures and fittings
- Storage cupboard
- Anti slip shower mat
- Ducted blown air outlet
- LED lighting
- Retractable clothes line (model specific)
- Roof vent with flyscreen



Your Motorhome. Your Way.

Auto-Sleepers have been hand-crafting motorhomes to stand the test of time for over 54 years and we believe that your motorhome should be tailored to be exactly how you want it. That's why we offer numerous personalisation options to enable you to customise your vehicle to meet your requirements.

Roof Options

Peugeot and Mercedes-Benz coachbuilt models are available with a choice of two roof options, available at no extra cost.



Low Profile

The lowline roof is available with either a large opening skyview rooflight or additional locker storage.



Luton

The overcab luton offers additional sleeping accommodation for two people. Not available on Corinium range.

Seating Options

Selected Coachbuilt models are available with the option of two rear seating configurations. Choose from either twin benches, creating a spacious lounge or additional rear travelling seats**, which allow for extra passengers to be transported in the rear safely.



Twin Bench Lounge



Additional Rear Travelling Seats

Fabric Options

Every Auto-Sleeper comes with a choice of colourways from the latest range of handpicked Belgian 'Catalan', 'Casa Milà' or 'Sagrada' fabrics, providing a luxurious finish for that added personal touch.

Catalan



Casa Milà ^{NEW}

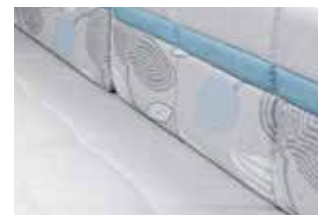

Sagrada ^{NEW}



Seat Belt Safety

Seat belts for the front cab seats in motorhomes have always been installed by the base vehicle manufacturer since the law required them to do so and wearing them is a legal requirement whenever the vehicle is being driven.

Seat belts in the rear of a motorhomes however is more complicated; where a designated travelling seat is available it must be used, however, where there isn't one it's not illegal to travel in the rear without wearing one at present, although this could well change in the future.

In the interests of everyone's safety and peace of mind, Auto-Sleepers always recommend when travelling in the rear of a motorhome, it should be in a designated travelling seat with the three point seat-belts in use.

Look out for the red seat-belt symbol next to the layout to indicate the availability of designated rear travel seats which have been tested and approved as fully compliant with European whole vehicle type approval for your total safety and peace of mind.



Situation	Front Seat	Rear Seat	Responsibility
Driver	Seat belt must be worn if fitted	-	Driver
Child under 3 years of age	Seat belt must be worn if fitted	Correct child restraint must be used	Driver
Child from 3rd birthday up to 135cm in height or 12th birthday, whichever they reach first.	Correct child restraint must be used	Correct child restraint must be used where seatbelts are fitted. Must use adult belt in rear seat if correct child restraint is not available.	Driver
Child 12 or 13 years of age or over 135cm in height	Seat belt must be worn if fitted	Seat belt must be worn if fitted	Driver
Adult passengers	Seat belt must be worn if fitted	Seat belt must be worn if fitted	Passenger



Grade 3 Insulation >

All Year Round Comfort

All models in the 2018 Auto-Sleepers motorhome range meet the NCC EN1646-1 Grade III classification for heating and thermal insulation, meaning every 2017 model excels in any environment to deliver luxurious year round touring comfort.

The classification was achieved after completing rigorous testing inside Truma's state of the art Cold Chamber facility in Derby, where the vehicles were subjected to extreme temperatures of -15°C which is extremely challenging for an all steel body to overcome as it absorbs the cold and fights the heating system.

In order to achieve Grade III status, the centre of the interior must achieve a minimum temperature of +20°C within a 4 hour period despite the freezing temperatures surrounding the vehicle throughout the test. Auto-Sleepers new tank heater blankets, which form part of the new winter pack, allow for free flowing water meaning Auto-Sleeper will excel in any environment for true Motorhoming freedom.



AdBlue®

Advanced Emissions Control For Diesel Engines

Auto-Sleepers 2018 motorhome range engines will feature Selective Catalytic Reduction (SCR) using AdBlue®*, a water/urea based additive which is stored in a tank (like diesel fuel), however, unlike fuel it is not injected into the engine, but directly into a specially modified part of the vehicle's exhaust. This begins a chemical reaction which removes the polluting oxides of nitrogen (NOx), converting them into harmless oxygen and nitrogen in a process known as Selective Catalytic Reduction, or SCR for short. SCR is only applicable to diesel engines and the more economically you drive, typically, the less AdBlue® you will use.

Easy AdBlue® Filling

Access from the outside to the AdBlue refill located under the fuel filler.



How will I know if the system needs topping-up?

A series of warnings will be given via the driver information system, accompanied by advice/messages. The first message is displayed when the remaining range is approximately 1,500 miles, and is repeated every 62 miles until the range reaches 1,000 miles, at which point the warning turns amber. This warning is repeated every 31 miles and is accompanied by an audible tone. If these warnings are not acted upon, the warning turns red; once this happens the motorhome will not restart once the ignition is turned off. This is not a fault, but a required feature of the system. If this stage is reached the system will need a full top-up before the motorhome can be restarted. Further information is available in the vehicle handbook.

Important Information

- AdBlue® is not a fuel additive. This is why there is a separate AdBlue® tank
- If you put AdBlue® in your fuel tank by mistake, please do not start the engine, but contact a retailer for help
- Put only AdBlue® in the AdBlue® tank; do not fill the AdBlue® tank with any other liquids
- Prevent anything from contaminating AdBlue®
- If small quantities of AdBlue® come into contact with the vehicle's paintwork, for example, wipe them off and if necessary rinse the area with water

* Models built on a Fiat chassis will not feature SCR using AdBlue®, utilising NOX Trap technology instead



PROFESSIONAL

Fiat Comfort-matic Gearbox

Automatic Comfort

Optional Fiat Ducato 130/150bhp Comfort-Matic Gearbox on all Auto-Sleeper 2018 Peugeot Models Comfort-Matic, the gearbox that ensures an easy, fuel-efficient drive and respects the environment. The robotic gearbox works for you, offering the strength and precision of a manual gearbox, with the comfort and ease of an automatic gearbox. The Comfort-Matic also comes with a number of special features designed specifically for motorhomes. With the Comfort-matic installed all that is left to do is enjoy!

Please note: Colour co-ordinated door handles not available on Fiat Chassis Models

SPECIFICATION
& AFTER-SALES

Media Pack >

Home Entertainment On The Move

Press and go, the convenience of having all your TV channels ready to watch in an instant with the Auto-Sleepers' Media Pack. The pack features the Maxview VuQube II Automatic Satellite System, a versatile portable or roof mountable satellite system providing you with TV and radio coverage throughout the UK and Europe.

Fully automatic

Includes a compact and easy to use LED control box, powered by your receiver, to automatically locate the correct satellite with a single button-press. Complete with operation manual, set up guide and 2 year warranty.

Key Features:

- Dynamic dish levelling allows the system to be placed on uneven surfaces.
- Twin LNB as Standard. For use with PVR's, SKY+™ or 2 receivers in different locations
- Fully Automatic: Includes a compact control box to automatically locate the correct satellite with a single button-press
- Clear and easy to use LED control box
- Powered by your receiver
- Ultra-lightweight with ergonomically designed carry-handle
- A 50cm offset dish giving this satellite an increased range
- Includes a built in security loop to enable it to be attached to your vehicle or imovable object for safekeeping
- All weather resistant and robust casing
- Includes 2 x 10M of cable allowing easy positioning
- Complete with operation manual & set up guide
- Receives transmissions from Astra 1, Astra 2, Astra 3 and Hotbird
- Compatible with any SD/HD Free to air satellite receivers



Media Pack+ >

Enhanced Reception Performance

The Auto-Sleepers Media Pack+ Upgrade features the Maxview Target Satellite System for increased performance and coverage. The system includes five pre-programmed satellites as standard (ASTRA 1, 2, 3, Hot bird & Thor) with an easy-to-use, wired control box and an 'Easy adjust' manual skew system. A low, stream-lined profile means that the fully-automatic satellite system is 17cm high in the parked position and it has an all-weather-resistant construction.

Future proof design

Periodically all automatic satellite systems may require an update to enable them to lock on to the selected signal. Maxview have designed the Target with this in mind making it easy for you to update. Simply load new software onto a USB stick and insert into the control box. Your system is then upgraded to locate and lock onto the new satellite settings.

Key Features:

- Performance and coverage better than any Dome Satellite System
- Single, Twin and Quad LNB variants available (For PVR's, SKY+ or 2 receivers)
- Enhanced gearbox design for increased positional accuracy and reliability
- Mounting brackets included to fix Control Box conveniently inside a cupboard
- Easy adjust manual skew system
- Designed and tested for outdoor use
- High quality, durable and robust construction
- Designed and manufactured in the UK
- 3 year guarantee
- Complete with operation manual & set up guide
- Receives transmissions from Astra 1, Astra 2, Astra 3 and Hotbird
- Compatible with any SD/HD Free to air satellite receivers



Media Pack^{DX} >

Cutting-edge technology in a compact design for incredible reception range

The Auto-Sleepers Media Pack^{DX} Upgrade features Oyster's New Cytrac^{DX}® Satellite System. The innovative antenna technology that facilitates the enormous reception range forms the heart of the Cytrac^{DX}® system. It comprises 1016 interlinked single antennas arranged in a honeycomb pattern. This results in a reception range that is several hundred kilometres larger than that of an equally-sized flat-dish antenna.

The light-weight Cytrac^{DX}® system is only 14 cm high. Thanks to its compact design, it fits onto almost any vehicle roof. Its robust exterior unit is made of cast aluminium and requires only little space as it rotates in open position only. The system is mechanically reinforced to resist even strong gusts of wind. Its surfaces are made of highly weather-resistant PC-ASA plastic to shed off hail without taking any damage. A hail cover is therefore obsolete.

Operating the Cytrac^{DX}® system is easy and intuitive as it automatically aims itself at the selected satellite.

Key Features:

- Small, compact antenna for space-saving installation on the vehicle roof
- Fully automated satellite searching and aiming in 30 to 60 seconds
- LEM technology for reduced search times (system stores last elevation angle)
- Automatic retraction at vehicle start
- High-quality craftsmanship and durable materials
- Solid, reliable design using PC-ASA plastic that even resists hail



SPECIFICATION
& AFTER-SALES



The only
Auto-Sleepers
Recommended
Partner for Paint and
Upholstery Protection



Paint Protection



Upholstery and Carpet Protection

The only
one with the
Lifetime
Guarantee

From the Makers of Diamondbrite. **Diamondbrite Leisure.** *The ultimate Paint and Upholstery Protection for your Auto-Sleepers motorhome*

Diamondbrite Leisure is a two-step protection system for your Auto-Sleepers motorhome with a Lifetime Guarantee*

1. EXTERIOR

- Nano-Ceramic Technology
- Fade Resistant
- Never Polish Again!

2. INTERIOR

- Easy to Clean
- Stain Resistant
- Lifetime Guarantee

HOW DOES IT WORK?

1 If your paintwork was magnified it would reveal small pores in the surface.

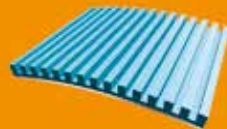

2 Road traffic dirt gathers in the pores and attacks paintwork.

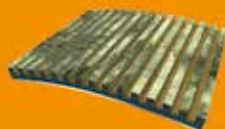

3 Your first Paint Protection application cleanses and fills pores in the vehicles paintwork leaving a smooth finish that cannot be penetrated.



4 Your second application bonds with the first to create a hard protective skin. It leaves a high lustre finish that rain and dirt cannot penetrate.



You will also receive a complimentary After Care pack including the fabulous Waterless Wash, plus a range of other professional cleaning products.

Jewelultra Ltd. Diamondbrite House, Ewell Lane,
West Farleigh, MAIDSTONE. ME15 ONG.

Tel 01622 815679
Email diamondbrite@jewelultra.com



www.jewelultra.com



*Lifetime Guarantee applies for the length of time that the purchaser owns the vehicle and is non-transferable.

Trackstar Leisure >

Leisure Vehicle Tracking

The Trackstar Leisure system is a fully Thatcham approved Category 6 caravan tracking system using a secure GPS/GSM unit to communicate with the 24/7 Trackstar monitoring Control Centre..

- GPS for location accuracy
- Secure GSM Communication to 24/7 Trackstar Monitoring Centre
- Pan European Protection
- Smartphone App to view Caravan location, journeys and set geofence alarms
- Key switch to arm and disarm system
- Remote control arm and disarm (available at additional cost)
- Insurance Industry Approved
- Internal Lithium Battery back up
- Low Power Consumption
- Up to 12 months tracking from a fully charged leisure battery
- Weekly Health Check
- Police Endorsed



2018 Auto-Sleepers Motorhomes include the Trackstar Leisure system with 1 Year subscription
 1 Year additional Subscription: £99.00
 3 Year additional Subscription: £249.00



Trust us to insure your freedom

Caravan Guard offers a 27.5% motorhome insurance discount to reward the fitment of the Trackstar Leisure tracking system to 2018 Auto-Sleepers motorhomes

Avtex Tourer One >

Caravan & Motorhome Club Edition Satellite Navigation System

The new Avtex Tourer One has been developed through a collaboration between Avtex and satellite navigation industry leaders Garmin and comes packed with features specifically for use with Caravans and Motorhomes and being the Caravan & Motorhome Club Edition this unit has all the Club data allowing you to search and filter and view all the best Caravan & Motorhome Club sites. Package Includes:

- 7" Frameless Display guides you to your destination with a pinch-to-zoom, capacitive glass display and easy route shaping feature
- Motorhome & Caravan vehicle profile shows speed limits, height restrictions and driver alerts for sharp curves and more
- Three exclusive Caravan & Motorhome Club data bases
- Extensive European Caravan & Motorhome site data bases
- Free European Lifetime Map updates via PC, Mac or Wi-fi
- Free lifetime digital traffic
- Road warnings, Elevation profile, Fatigue warning and Driver Alerts
- Hands-free features include Bluetooth® calling, smart notifications and voice-activated navigation
- Navigate complex interchanges with "spoken turn-by-turn" directions and active lane guidance
- TripAdvisor Travel POIs with ratings
- BC™ 30 Wireless Backup Camera (fitting included)



SPECIFICATION & AFTER-SALES



More Comfort On Tour

Aventa Air Conditioning System

Peugeot van conversions, coachbuilts and Mercedes coachbuilts all have the option of having an Aventa Eco Air Conditioning system installed. The Truma roof air conditioner excels with its performance power – Although being especially efficient and economical in consumption the Aventa turns the vehicles into a feel good zone thanks to its high performance. The powerful cooling capacity ensures this on hot summer days. In cool nights the economical heat pump function (2 ventilation steps) for pleasant temperatures. At the same time the air is not only dehumidified, but also cleaned by a new honeycombed air filter.

The integrated sleep-mode reduces speed of the ventilator in the night and so by very silent air distribution a particular smooth running of the air conditioner is achieved. The single adjustable air-outlets offer various possibilities to dispense the conditioned air in the vehicle.

Truma iNet System

More comfort on the move in a new dimension: The Truma iNet System enables the Combi heater and Truma air conditioning systems to be remotely controlled anywhere and anytime; be it on the ski slopes, at the beach or when hiking. The Truma iNet System allows you to control the units easily and simply via the Truma app from wherever you are, and to query the current device and vehicle status. This makes camping much more easy, comfortable and safe.

Truma Combi CP plus

Just set your own comfort zone with the Combi CP plus boiler from Truma. The Combi CP provides heating and hot water boiler in one device and the practical turn-and-push controls of the digital control panel make operation of the system really easy.

You can intuitively select the required room or water temperature, and the Boost function offered by the CP plus adds real value: it warms the water even faster, and heats the leisure vehicle to a pleasant temperature – at the push of a button.

This digital high performer even lets you determine the energy source, adjust the fan, or programme the functions of your Combi heater or air conditioning unit by times.



Safe Heating On The Move

Drive Safe Regulator

For 2018 all Auto-Sleeper models feature an innovative gas pressure regulator from Truma. It offers its users a safe and convenient supply of gas when on the move. With an integrated gas flow monitor, you can use your liquid gas heater whilst driving.

How safe is it to operate a gas system for heating while you are on the move? Truma has the answer: for years, we have been further developing technical standards for protective devices that enable heating whilst driving; and now we have also incorporated a crash sensor into our new generation of gas pressure regulation systems.

This sensor even responds to accidents that take place at low impact speeds of 15–20 km/h, closing the gas supply before damage can be caused to the lines or devices.

So you can arrive at your destination with everyone feeling relaxed, reassured, and safe. Truma gas pressure regulation systems offer everything required to ensure safe heating on the move, throughout the whole of Europe.

For further information on Truma products please visit:
<https://www.truma.com/uk/en/home/>



www.asoc.uk.com

Owners' Club

The Auto-Sleepers Owners' Club was formed in 1989 and now has a membership exceeding 2,400. Closely allied with the Company, membership of the Club is open to all Auto-Sleepers owners. Benefits include a monthly newsletter and rallies throughout the year, both at home and abroad. Enquiry forms are available through the Company or by visiting the club website.

SPECIFICATION
& AFTER-SALES





Service >

Auto-Sleepers Aftercare & Service Centre

The Auto-Sleepers Service Centre caters specifically for the needs of the motorhome and caravan owner. Located on site at the Auto-Sleepers factory in Willersey, Worcestershire, we offer mechanical and conversion servicing, accident and insurance repairs, annual habitation checks, MOT testing, accessory fittings, modifications and refurbishments.

The Service centre has also been granted Approved Workshop status by the NCC. The Approved Workshop Scheme is a joint enterprise between the NCC (National Caravan Council), The Caravan Club and The Camping and Caravanning Club. It is the benchmark for motorhome and touring caravan servicing. To comply with the Scheme's rigorous standards Auto-Sleeper have invested heavily in training and additional equipment, along with a purpose designed computer system.

To find out more about motorhome servicing please visit:
<http://www.auto-sleepers.com/motorhome-servicing/>

To find out more about caravan services here please visit:
<http://www.auto-sleepers.com/caravan-servicing/>



Auto-Sleepers Parts Department

The Auto-Sleepers Parts Department aims to provide parts for Auto-Sleepers old and new. When contacting this Department, customers should have to hand the Auto-Sleepers production number of their vehicle. We endeavour to provide parts for older vehicles, but are unable to guarantee to supply parts that are no longer manufactured by our suppliers.

Contact Us

Opening hours:
Mon - Thurs : 7:30am - 5pm
Fri: 7.30am-3pm
Sat-Sun: Closed

Service Department
+44 (0) 1386 853511
Parts Department
+44 (0) 1386 842630



Warranty >

Auto-Sleepers Conversion Warranty

You can be confident about owning an Auto-Sleepers, because we are confident about the way in which we build them. The conversion work of every Auto-Sleepers is covered by our own three year warranty* scheme plus and an additional three year water ingress warranty*. The cover is not restricted to mileage and protects all aspects of the conversion. Terms and conditions apply, please refer to your handbook for further information.

Mercedes-Benz Warranty

The base of your motorhome is covered by Mercedes-Benz. You are covered by a 3 year, unlimited mileage warranty (terms and conditions apply, please refer to the chassis manufacturers handbook for details).

Mobilovan UK

Mobilovan UK keeps the Mercedes-Benz Van Owner On The Road For Thirty Years - Mercedes vans first registered after 1st October 2012. To benefit from Mobilovan UK, the owner must have the van regularly serviced by a Mercedes-Benz service partner. Even if it is a used van or a service has been missed, with each new service the van is automatically entitled to Mobilovan UK cover again, for up to 30 years.

Mobilovan UK also offers special mobility services in the event of a workshop visit arising from a warranty claim or goodwill gesture during the first three years after the van was initially registered.

Europe-Wide

Mobilovan UK cover applies throughout Europe even in a remote lane in Spain. Wherever there is a road, Mobilovan UK cover applies. A Europe-wide network of approximately 3,000 authorised Mercedes-Benz service partners makes this possible. And should it take a little longer to repair the vehicle, the owner can keep on the move thanks to the wide-ranging Mobilovan UK mobility services.

Technical Breakdowns Or Starting Problems

For three years after the initial registration of a Mercedes van, Mobilovan

UK will keep it on the move in the event of a technical breakdown or starting problems. Subsequently the mobility guarantee is extended after each service by an authorised Mercedes-Benz service partner – up to maximum of 30 years.

Minor Mishaps Or Driver Error

For three years after the initial registration of a Mercedes-Benz van Mobilovan UK will cover the following:

- Wrong fuel or out of fuel
- Lost or locked keys
- Two or more flat tyres
- Road traffic accident
- Vandalism and attempted theft

Workshop Visits For Warranty Repairs Of Over Two Hours

In the case of warranty claims or goodwill gestures in the 3 years following first registration of a Mercedes van the owner will be entitled to Mobilovan UK mobility services if the repair work exceeds 2 hours.

*Effective from 1st October 2017

Peugeot Warranty

All motorhomes first registered in the UK and purchased from a UK Peugeot Approved Manufacturer benefit from a Peugeot 3 Year unlimited mileage warranty and an 3 year paint guarantee provided by the Peugeot Dealer Network in the UK.

This additional warranty carries a mileage limit of 100,000 miles from first registration and is dependent upon the manufacturer's recommended servicing being carried out at the specified time or distance intervals. For full terms and conditions, please consult your Peugeot Dealer in the UK.

All new Peugeot motorhomes come with 12 months' Peugeot Assistance - breakdown assistance service. Peugeot Assistance includes European cover, homestart, roadside assistance, vehicle recovery and a free replacement car or hotel accommodation if required. For this service call 0800 294 0294

Fiat Warranty

Fiat provides a manufacturer's warranty for the base vehicle (as supplied to Auto-Sleepers) for a period of two years. For any issues with the base vehicle please contact your local Fiat dealer.

Your base vehicle warranty is subject to the terms and conditions contained in the respective chassis manufacturers' service literature. Your vehicle must be serviced in accordance with the chassis manufacturer's requirements.



Weights & Dimensions

	Van Conversions							Coachbuilds		
	Peugeot							Peugeot		
	Symbol	Stanway	Warwick Duo	Fairford	Kemerton XL	Kingham	Warwick XL	Nuevo EK	Nuevo ES	Broadway EB
Engine	160bhp	160bhp	160bhp	160bhp	160bhp	160bhp	160bhp	160bhp	160bhp	160bhp
Roof profile (low or overcab)	-	-	-	-	-	-	-	Low	Overcab	Low
Designated Passenger Seats (excl. driver)	2	3	1	3	2	1	1	1	3	1
Berths (sleeping positions)	2	2	2	4	2	2	2	2	4	2
Overall Length in mm**	5413mm 17'9"	5998mm 19'8"	5998mm 19'8"	6363mm 20' 11"	6363mm 20' 11"	6363mm 20' 11"	6363mm 20' 11"	5752mm 18'10"	5752mm 18'10"	6320mm 20'9"
Overall Width (mirrors folded)	2260mm 7'5"	2260mm 7'5"	2260mm 7'5"	2260mm 7' 5"	2260mm 7'5"	2260mm 7'5"	2260mm 7'5"	2320mm 7'7"	2320mm 7'7"	2320mm 7'7"
Overall Width (mirrors extended)	2508mm 8'3"	2508mm 8'3"	2508mm 8'3"	2508mm 8' 3"	2508mm 8'3"	2508mm 8'3"	2508mm 8'3"	2690mm 8'10"	2690mm 8'10"	2690mm 8'10"
Overall Height (incl TV aerial)	2640mm 8'8"	2640mm 8'8"	2640mm 8'8"	2640mm 8' 8"	2640mm 8'8"	2640mm 8'8"	2640mm 8'8"	2875mm 9'5"	3005mm 9'10"	2970mm 9'9"
Internal Height (max)	1900mm 6'3"	1900mm 6'3"	1900mm 6'3"	1900mm 6' 3"	1900mm 6'3"	1900mm 6'3"	1900mm 6'3"	1960mm 6'5"	1960mm 6'5"	1960mm 6'5"
Maximum Permissible Laden Mass (a) in kg	3300	3500	3500	3500	3500	3500	3500	3500	3500	3500
Mass in Running Order (b) in kg	2815	2938	2857	3076	3054	3067	3031	2824	2936	2981
Maximum User Payload (c) (c=a-b) in kg	485	562	643	424	446	433	469	676	564	519
Essential Habitation Equipment (d) in kg	10	10	10	10	10	10	10	17	17	17
Fresh Water Tank Size/ Waste Water Tank Size	69 litres/ 40 litres	69 litres/ 40 litres	69 litres/ 40 litres	69litres/ 40 litres	69 litres/ 40 litres	69 litres/ 40 litres	69 litres/ 40 litres	102 litres/ 71 litres	102 litres/ 71 litres	102 litres/ 71 litres
Bed Sizes										
Front Double	1860 x 1460mm 6' 1" x 4' 9"	1940x1340mm 6' 4"x4' 5"	-	1940x1340mm 6' 4"x4' 5"	1980 x 1880mm 6' 6" x 6' 2"	-	-	2100 x 1380mm 6'11" x 4'6"	2100 x 1380mm 6'11" x 4'6"	2100 x 1350mm 6'11" x 4'5"
Rear Double	-	-	1870 x 1850mm 6' 2" x 6' 1"	1870 x 1220mm 6' 2" x 4'0"	-	1900 x 1200mm 6' 3" x 4' 0"	1870 x 1920mm 6' 2" x 6' 4"	-	-	-
Nearside Single	1940 x 630mm 6' 4" x 2'1"	-	1850 x 680mm 6' 1" x 2' 3"	-	1980 x 680mm 6' 6" x 2' 3"	-	1900 x 700mm 6' 3" x 2' 4"	1900 x 700mm 6'3" x 2'4"	1900 x 700mm 6'3" x 2'4"	1930 x 700mm 6'4" x 2'4"
Offside Single	1715 x 700mm 5' 8" x 2' 4"	-	1850 x 680mm 6' 1" x 2' 3"	-	2050 x 700 6' 9" x 2' 4"	-	1900 x 700mm 6' 3" x 2' 4"	1880 x 700mm 6'2" x 2'4"	1800 x 900mm 5'11" x 2'11"	1930 x 700mm 6'4" x 2'4"
Roof Bed	-	-	-	-	-	-	-	-	1940 x 1280mm 6' 4" x 4' 2"	-

The MRO is the mass of the unladen vehicle, including an allowance for the driver (assumed 75 kg) and a 90% full fuel tank. The MRO is calculated with the fresh water tank empty.

If you travel with water in the freshwater tank then the User Payload will reduce accordingly.

The optional Comfort-Matic gearbox on the Fiat chassis will increase the MRO by 50 kg and therefore reducing the user payload by the same amount.

Coachbuilts

Peugeot			Peugeot AL-KO						Mercedes-Benz											
Broadway EK	Broadway EK TB LP	Broadway FB	Corinium FB		Corinium Duo		Corinium RB		Stanton		Bourton	Winchcombe	Malvern	Burford		Burford Duo				
160bhp	160bhp	160bhp	160bhp	160bhp Weight Upgrade	160bhp	160bhp Weight Upgrade	160bhp	160bhp Weight upgrade	163bhp Auto	163bhp Auto Weight Upgrade	163bhp Auto	163bhp Auto	163bhp Auto	163bhp Auto	163bhp Auto	163bhp Auto Weight Upgrade	163bhp Auto Weight Upgrade			
Overcab	Low	Low	Low		Low		Low		Low		Low	Low	Low	Low	Low		Low			
3	1	1	1		1		1		1		1	1	1	1	1		1			
4	2	4	4		4		4		2		2	2	2	4	4		4			
6320mm 20'9"	6320mm 20'9"	7205mm 23'8"	7755mm 25'5"		7755mm 25'5"		7755mm 25'5"		5980mm 19'7"		6485mm 21'3"		7330mm 24'1"		7920mm 26'0"		7920mm 26'0"			
2320mm 7'7"	2320mm 7'7"	2320mm 7'7"	2320mm 7'7"		2320mm 7'7"		2320mm 7'7"		2260mm 7'5"		2260mm 7'5"		2350mm 7'9"		2350mm 7'9"		2350mm 7'9"			
2690mm 8'10"	2690mm 8'10"	2690mm 8'10"	2690mm 8'10"		2690mm 8'10"		2690mm 8'10"		2660mm 8'9"		2660mm 8'9"		2780mm 9'1"		2780mm 9'1"		2780mm 9'1"			
3005mm 9'10"	2970mm 9'9"	2930mm 9'7"	2900mm 9'6"		2900mm 9'6"		2900mm 9'6"		2850mm 9'4"		2860mm 9'5"		2860mm 9'5"		2860mm 9'5"		2880mm 9'6"			
1960mm 6'5"	1960mm 6'5"	1960mm 6'5"	1960mm 6'5"		1960mm 6'5"		1960mm 6'5"		1960mm 6'5"		1960mm 6'5"		1960mm 6'5"		1960mm 6'5"		1960mm 6'5"			
3500	3500	3500	3500	4000	3500	4000	3500	4000	3200	3500	3500		3880	3880	3880	4000	3880	4000		
3081	2969	3112	3207#	3292	3137#	3222	3237#	3322	2849		2983		3238		3221		3453	3453	3383	3383
419	531	388	293	708	363	778	263	678	351	651	517		642		659		427	547	497	617
17	17	25	17		17		17		17		17		25		17		17			
102 litres/ 71 litres	102 litres/ 71 litres	102 litres/ 91 litres	91 litres/ 71 litres		91 litres/ 71 litres		91 litres/ 71 litres		71 litres/53 litres		62 litres/ 53 litres		91 litres/ 71 litres		91 litres/ 78 litres		91 litres/ 91 litres		91 litres/ 91 litres	
2100 x 1840mm 6' 11" x 6' 0"	2100 x 1930mm 6'11" x 6'4"	2100 x 1220mm 6'11" x 4'0"	2210x1220mm 7'3"x4'0"		2210x1220mm 7'3"x4'0"		2210x1220mm 7'3"x4'0"		2100 x 1400mm 6'11" x 4'7"		2100 x 1920mm 6'11" x 6'4"		2210 x 1270mm 7'3" x 4'2"		2210 x 1220mm 7'3" x 4'0"		2210 x 1220mm 7'3" x 4'0"			
-	-	1940 x 1250mm 6'4" x 4'1"	1860 x 1300mm 6'1" x 4'3"		-		1940x1220mm 6'4"x4'0"		-		-		-		1980 x 1370mm 6'6" x 4'6"		1860 x 1300mm 6'1" x 4'3"		-	
1930 x 680mm 6'4" x 2'3"	1930 x 700mm 6'4" x 2'4"	-	-		1860 x 780mm 6'1" x 2'7"		-		1930 x 700 6' 4" x 2' 4"		1920 x 730mm 6'4" x 2'5"		1940 x 700mm 6'4" x 2'4"		-		-		1860 x 780mm 6'1" x 2'7"	
1840 x 930mm 6'0" x 3'1"	1860 x 700mm 6'2" x 2'4"	-	-		1860 x 780mm 6'1" x 2'7"		-		1930 x 700 6' 4" x 2' 4"		1920 x 730mm 6'4" x 2'5"		1900 x 700mm 6'3" x 2'4"		-		-		1860 x 780mm 6'1" x 2'7"	
1940 x 1280 6' 4" x 4' 2"	-	-	-		-		-		-		-		-		-		-		-	

The Maximum User Payload includes:

- Conventional load, is the allowance for passengers
- Essential habitation equipment includes items and/or fluids required for safe and proper functioning of the habitation equipment.

- Optional equipment is items available from the manufacturer over and above the standard specification.
- Personal effects, items not effected by the above.





Auto-Sleepers

MOTORHOMES OF EXCELLENCE

Auto-Sleepers Limited, Orchard Works, Willersey, Nr Broadway, Worcestershire WR12 7QF, England

Tel: +44 (0)1386 853338 Fax: +44 (0)1386 858343

www.auto-sleepers.com

This brochure does not constitute an offer by the Auto-Sleepers Group Ltd (Auto-Sleepers). It's the continual policy of Peugeot, Mercedes-Benz, Fiat and Auto-Sleepers to seek to improve their vehicles in every way and so whilst every effort has been made to ensure the details set out in this brochure were correct at the time of going to press, they are unable to guarantee that no changes in specification have subsequently taken place. They therefore reserve the right to alter the specifications and price at any time without notice. Auto-Sleepers designs its Motorhomes to provide a variety of potential uses for its customers. Each vehicle features the optimum storage, fluid, seating and sleeping capabilities. While the customer enjoys this potential, they have the responsibility to select the proper combinations of loads without exceeding the chassis weight capacities. Bedding and "dress" items shown in photography are used for illustrative purposes only and are not part of the vehicle specification. The End Of Life Vehicle Directive for Peugeot - visit www.peugeot.co.uk under the Environment section. For more details on Mercedes - visit www2.mercedes-benz.co.uk, and for Fiat - visit <http://www.fiatprofessional.co.uk/services/assistance/end-of-life-vehicle-collection>. Please note that imperial conversions have been rounded to the nearest inch. Dimensions are based on vehicles with standard wheels. All weights and dimensions are subject to manufacturing tolerances and refer to standard specification models and do not include any options. Effective 1st October 2017. This literature supersedes all others. E&OE